

09-18 LIGHTING SYSTEMS

LOCATION INDEX	09-18-2	BACK-UP LIGHT SWITCH	
FRONT COMBINATION LIGHT		REMOVAL/INSTALLATION	09-18-15
REMOVAL/INSTALLATION	09-18-5	BACK-UP LIGHT SWITCH INSPECTION	09-18-15
HEADLIGHT ADJUSTMENT	09-18-5	FLASHER CONTROL MODULE	
HEADLIGHT BULB		REMOVAL/INSTALLATION	09-18-16
REMOVAL/INSTALLATION	09-18-6	FLASHER CONTROL MODULE	
Headlight Bulb Removal Note		INSPECTION	09-18-16
(4SD and 5HB Low-beam).....	09-18-6	Terminal Voltage List (Reference)	09-18-16
Headlight Bulb Removal Note		DAYTIME RUNNING LIGHT (DRL)	
(5HB High-beam).....	09-18-6	SYSTEM WIRING DIAGRAM	09-18-17
Cover Installation Note.....	09-18-6	DRL CONTROL MODULE	
FRONT TURN LIGHT/PARKING LIGHT BULB		REMOVAL/INSTALLATION (CANADA)	09-18-18
REMOVAL/INSTALLATION	09-18-7	DRL CONTROL MODULE INSPECTION	
FRONT SIDE MARKER LIGHT		(CANADA)	09-18-18
REMOVAL/INSTALLATION	09-18-7	Terminal Voltage List (Reference)	09-18-18
4SD	09-18-7	INTERIOR AND MAP LIGHT	
5HB	09-18-7	REMOVAL/INSTALLATION	09-18-20
FRONT FOG LIGHT		Lens Removal Note.....	09-18-20
REMOVAL/INSTALLATION	09-18-8	INTERIOR AND MAP LIGHT	
4SD	09-18-8	INSPECTION	09-18-20
5HB	09-18-8	MAP LIGHT REMOVAL/INSTALLATION	09-18-21
FRONT FOG LIGHT ADJUSTMENT	09-18-9	Lens Removal Note.....	09-18-21
REAR COMBINATION LIGHT		MAP LIGHT INSPECTION	09-18-21
REMOVAL/INSTALLATION	09-18-10	INTERIOR LIGHT	
Socket Installation Note	09-18-10	REMOVAL/INSTALLATION	09-18-22
HIGH-MOUNT BRAKE LIGHT		Lens Removal Note.....	09-18-22
REMOVAL/INSTALLATION	09-18-11	INTERIOR LIGHT INSPECTION	09-18-22
In-Vehicle Type	09-18-11	TRUNK COMPARTMENT LIGHT BULB	
Rear Spoiler Type	09-18-11	REMOVAL/INSTALLATION	09-18-23
LICENSE PLATE LIGHT		TRUNK COMPARTMENT LIGHT SWITCH	
REMOVAL/INSTALLATION	09-18-12	INSPECTION	09-18-23
License Plate Light Removal Note....	09-18-12	CARGO COMPARTMENT LIGHT	
COMBINATION SWITCH		REMOVAL/INSTALLATION	09-18-23
REMOVAL/INSTALLATION	09-18-12	CARGO COMPARTMENT LIGHT	
COMBINATION SWITCH DISASSEMBLY/ ASSEMBLY	09-18-13	INSPECTION	09-18-24
LIGHT SWITCH		CARGO COMPARTMENT LIGHT SWITCH	
REMOVAL/INSTALLATION	09-18-13	INSPECTION	09-18-24
LIGHT SWITCH INSPECTION	09-18-13	IGNITION KEY ILLUMINATION BULB	
Headlight switch.....	09-18-13	REMOVAL/INSTALLATION	09-18-24
Turn switch.....	09-18-14	DOOR SWITCH	
FRONT FOG LIGHT SWITCH		REMOVAL/INSTALLATION	09-18-24
REMOVAL/INSTALLATION	09-18-14	Front	09-18-24
FRONT FOG LIGHT SWITCH		Rear	09-18-25
INSPECTION	09-18-14	DOOR SWITCH INSPECTION	09-18-25
HAZARD WARNING SWITCH		PANEL LIGHT CONTROL SWITCH	
REMOVAL/INSTALLATION	09-18-14	REMOVAL/INSTALLATION	09-18-25
HAZARD WARNING SWITCH		Panel Light Control Switch	
INSPECTION	09-18-15	Removal Note	09-18-25
		PANEL LIGHT CONTROL SWITCH	
		INSPECTION	09-18-26
		Terminal Voltage List (Reference)	09-18-26

09-18

LIGHTING SYSTEMS

LOCATION INDEX

A3U091801051W01

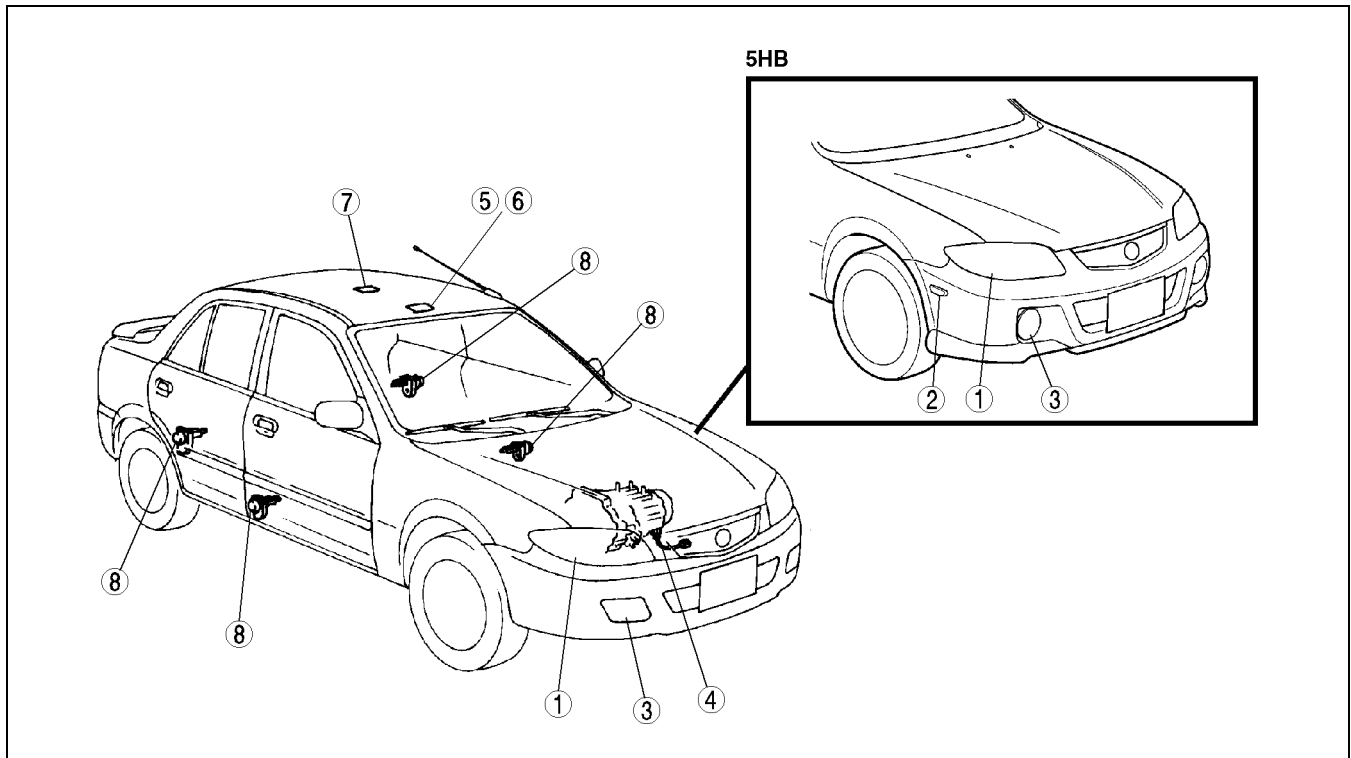

A3U0918W108

1	Front combination light (See 09-18-5 FRONT COMBINATION LIGHT REMOVAL/INSTALLATION) (See 09-18-5 HEADLIGHT ADJUSTMENT) (See 09-18-6 HEADLIGHT BULB REMOVAL/INSTALLATION) (See 09-18-7 FRONT TURN LIGHT/PARKING LIGHT BULB REMOVAL/INSTALLATION) (See 09-18-7 4SD)
2	Front side marker light (5HB) (See 09-18-7 5HB)
3	Front fog light (See 09-18-9 FRONT FOG LIGHT ADJUSTMENT) (See 09-18-8 FRONT FOG LIGHT REMOVAL/INSTALLATION)
4	Back-up light switch (See 09-18-15 BACK-UP LIGHT SWITCH REMOVAL/INSTALLATION) (See 09-18-15 BACK-UP LIGHT SWITCH INSPECTION)

5	Interior and map light (See 09-18-20 INTERIOR AND MAP LIGHT REMOVAL/INSTALLATION) (See 09-18-20 INTERIOR AND MAP LIGHT INSPECTION)
6	Map light (See 09-18-21 MAP LIGHT REMOVAL/INSTALLATION) (See 09-18-21 MAP LIGHT INSPECTION)
7	Interior light (See 09-18-22 INTERIOR LIGHT REMOVAL/INSTALLATION) (See 09-18-22 INTERIOR LIGHT INSPECTION)
8	Door switch (See 09-18-24 DOOR SWITCH REMOVAL/INSTALLATION) (See 09-18-25 DOOR SWITCH INSPECTION)

LIGHTING SYSTEMS

4SD

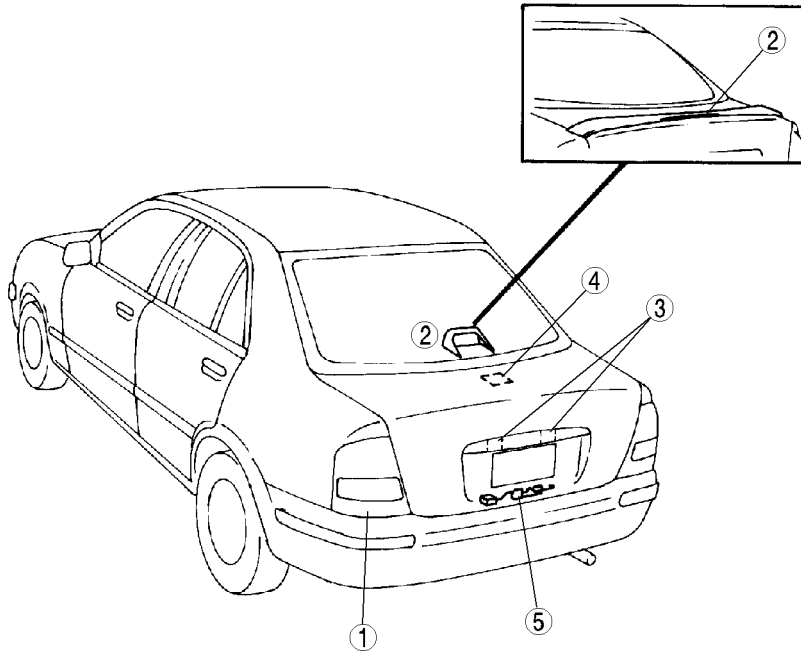

5HB

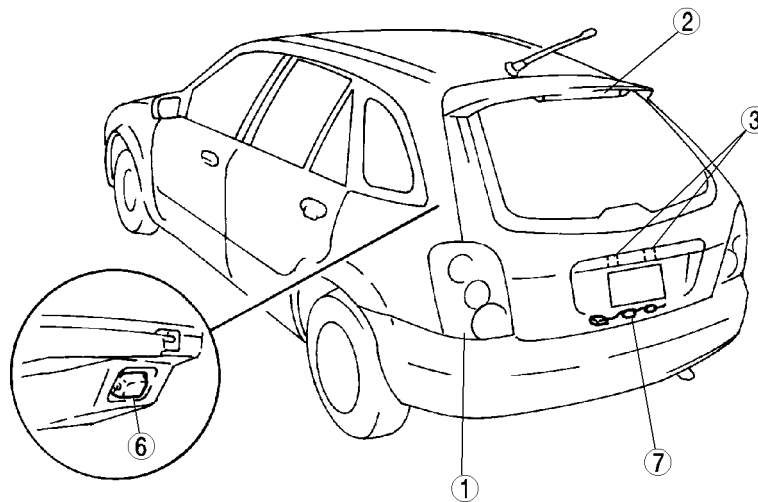

09-18

A3U0918W104

1	Rear combination light (See 09-18-10 REAR COMBINATION LIGHT REMOVAL/INSTALLATION)
2	High-mount brake light (See 09-18-11 HIGH-MOUNT BRAKE LIGHT REMOVAL/INSTALLATION)
3	License plate light (See 09-18-12 LICENSE PLATE LIGHT REMOVAL/INSTALLATION)
4	Trunk compartment light bulb (See 09-18-23 TRUNK COMPARTMENT LIGHT BULB REMOVAL/INSTALLATION)

5	Trunk compartment light switch (See 09-18-23 TRUNK COMPARTMENT LIGHT SWITCH INSPECTION)
6	Cargo compartment light (See 09-18-23 CARGO COMPARTMENT LIGHT REMOVAL/INSTALLATION) (See 09-18-24 CARGO COMPARTMENT LIGHT INSPECTION)
7	Cargo compartment light switch (See 09-18-24 CARGO COMPARTMENT LIGHT SWITCH INSPECTION)

LIGHTING SYSTEMS

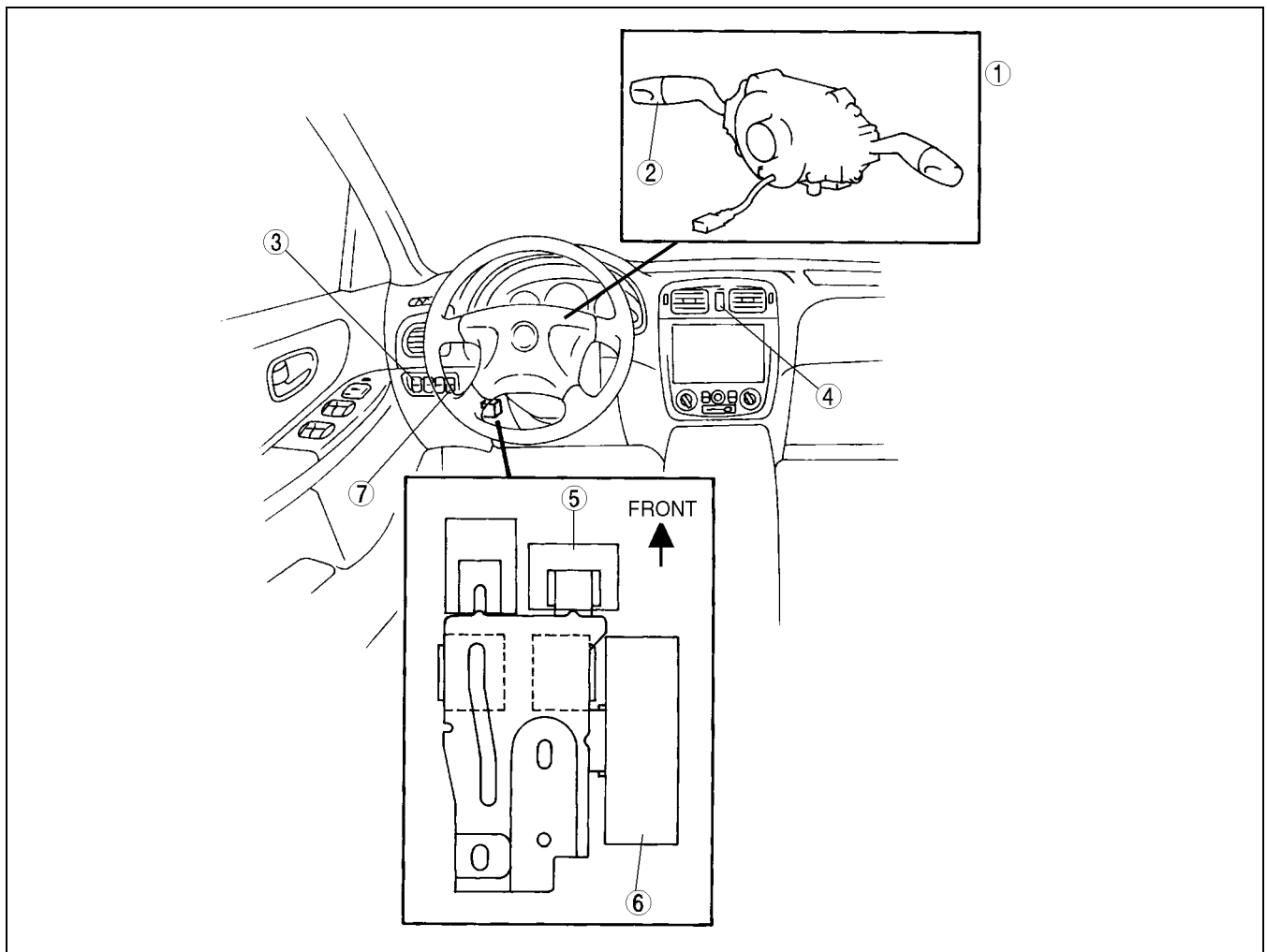

Z3U0918W013

1	Combination switch (See 09-18-12 COMBINATION SWITCH REMOVAL/INSTALLATION) (See 09-18-13 COMBINATION SWITCH DISASSEMBLY/ASSEMBLY)
2	Light switch (See 09-18-13 LIGHT SWITCH REMOVAL/INSTALLATION) (See 09-18-13 LIGHT SWITCH INSPECTION)
3	Front fog light switch (See 09-18-14 FRONT FOG LIGHT SWITCH REMOVAL/INSTALLATION) (See 09-18-14 FRONT FOG LIGHT SWITCH INSPECTION)
4	Hazard warning switch (See 09-18-14 HAZARD WARNING SWITCH REMOVAL/INSTALLATION) (See 09-18-15 HAZARD WARNING SWITCH INSPECTION)

5	Flasher control module (See 09-18-16 FLASHER CONTROL MODULE REMOVAL/INSTALLATION) (See 09-18-16 FLASHER CONTROL MODULE INSPECTION)
6	DRL control module (See 09-18-18 DRL CONTROL MODULE REMOVAL/INSTALLATION (CANADA)) (See 09-18-18 DRL CONTROL MODULE INSPECTION (CANADA))
7	Panel light control switch (See 09-18-25 PANEL LIGHT CONTROL SWITCH REMOVAL/INSTALLATION) (See 09-18-26 PANEL LIGHT CONTROL SWITCH INSPECTION)

LIGHTING SYSTEMS

FRONT COMBINATION LIGHT REMOVAL/INSTALLATION

A3U091851060W01

1. Disconnect the negative battery cable.
2. Remove the front bumper. (See 09-10-5 FRONT BUMPER REMOVAL/INSTALLATION.)
3. Remove in the order indicated in the table.

1	Connector
2	Bolt
3	Front combination light

4. Install in the reverse order of removal.
5. Adjust the headlight aiming. (See 09-18-5 HEADLIGHT ADJUSTMENT.)

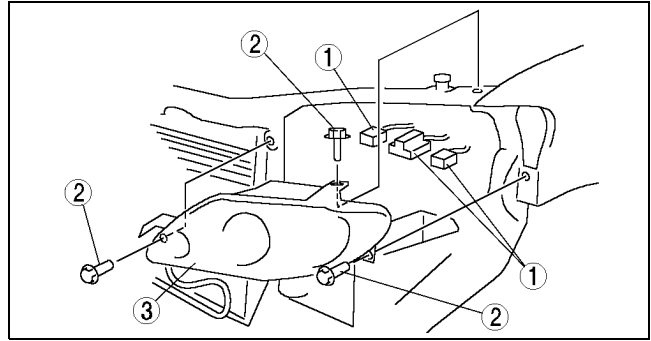

Y3J8112W111

HEADLIGHT ADJUSTMENT

A3U091851030W01

1. Adjust the tire air pressure to the specification.
2. Position the unloaded vehicle on a flat, level surface.
3. Seat one person in the driver's seat.
4. Position the vehicle straight ahead and perpendicular to a wall.
5. Set the headlights **3 m {10 ft}** from the wall.
6. While adjusting one headlight, disconnect the connector of the other.
7. Start the engine to charge the battery.
8. Turn on the low-beam headlight.

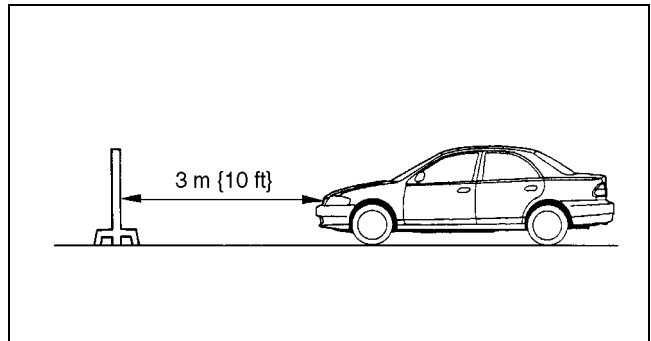

Z3U0918W006

9. Adjust the headlights by turning the adjusting screws as shown in the figure. Loosen the screws first, then tighten them.

Note

- If the adjusting screws are tightened first, then loosened, they will continue to loosen when the vehicle is in motion and may cause the headlights to become misaligned.

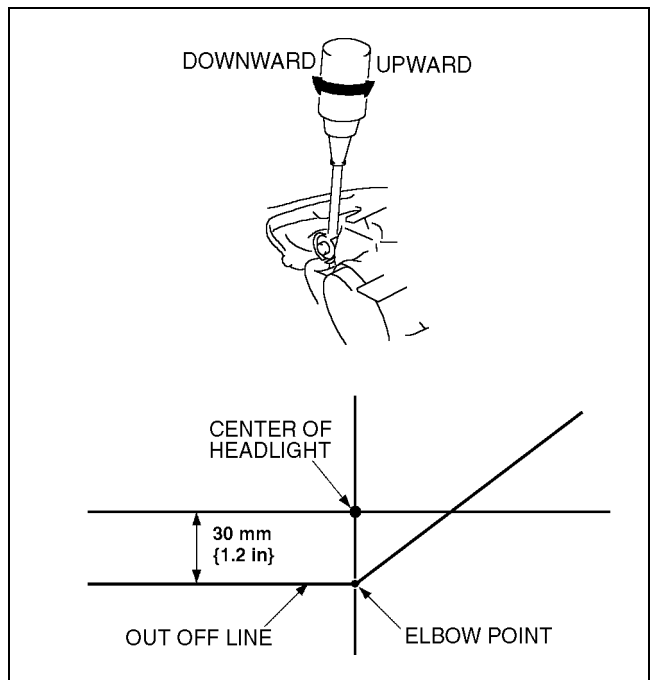

Z3U0918W001

LIGHTING SYSTEMS

A3U091851030W02

HEADLIGHT BULB REMOVAL/INSTALLATION

1. Disconnect the negative battery cable.
2. Remove in the order indicated in the table.

Caution

- A halogen bulb generates extremely high heat when it is used. If the surface of the bulb is dirty, excessive heat will build up and the light's life will be shortened. When replacing the bulb, hold the metal flange, not the glass.

3. Install in the reverse order of removal.

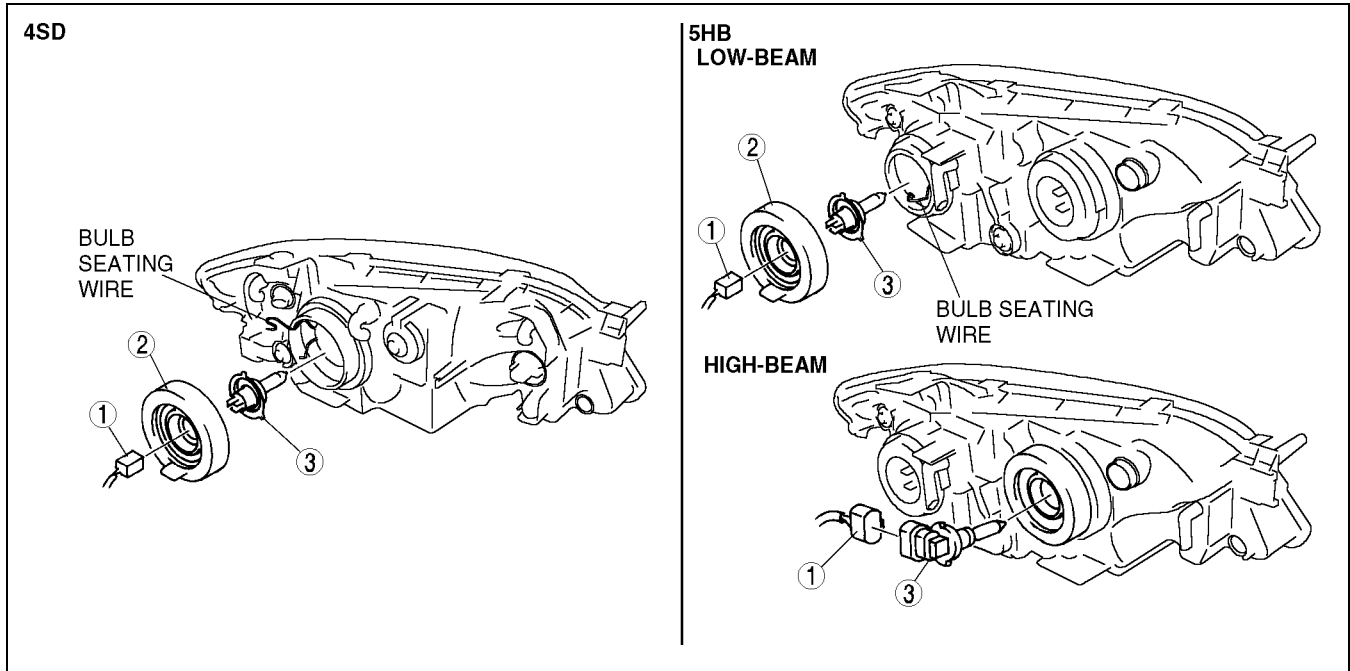

A3U0918W101

1	Connector
2	Cover (See 09-18-6 Cover Installation Note)

3	Headlight bulb (See 09-18-6 Headlight Bulb Removal Note (4SD and 5HB Low-beam)) (See 09-18-6 Headlight Bulb Removal Note (5HB High-beam))
---	---

Headlight Bulb Removal Note (4SD and 5HB Low-beam)

1. Release the bulb seating wire to remove the headlight bulb.

Headlight Bulb Removal Note (5HB High-beam)

1. Turn the bulb to remove the headlight bulb.

Cover Installation Note

1. Make sure the cover is seated properly to prevent the moisture from getting into the headlight housing.

LIGHTING SYSTEMS

FRONT TURN LIGHT/PARKING LIGHT BULB REMOVAL/INSTALLATION

A3U091851050W01

1. Disconnect the negative battery cable.
2. Remove in the order indicated in the table.

1	Connector
2	Socket
3	Front turn light/parking light bulb

3. Install in the reverse order of removal.

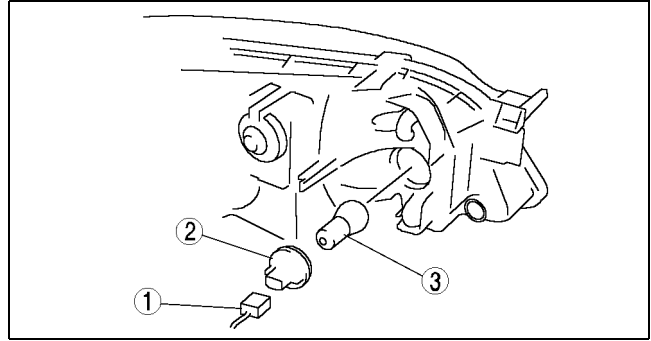

Y3J8112W107

FRONT SIDE MARKER LIGHT REMOVAL/INSTALLATION

A3U091851120W01

4SD

1. Disconnect the negative battery cable.
2. Remove in the order indicated in the table.

1	Socket
2	Connector
3	Front side marker light bulb

3. Install in the reverse order of removal.

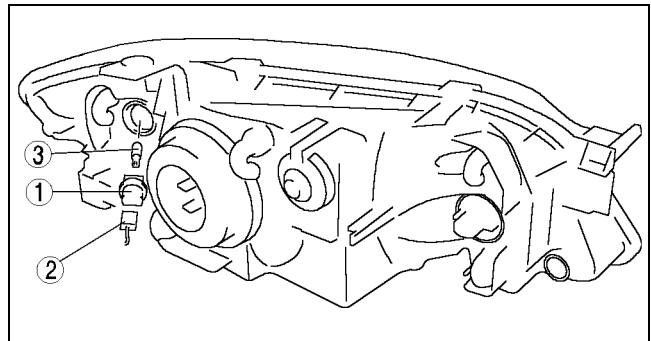

Z3U0918W002

09-18

5HB

1. Disconnect the negative battery cable.
2. Remove the bolts and fasteners, and bend the splash shield down.
3. Remove in the order indicated in the table.

1	Front side marker light (See 09-18-7 Front side marker light removal note)
2	Connector
3	Socket
4	Front side marker light bulb

4. Install in the reverse order of removal.

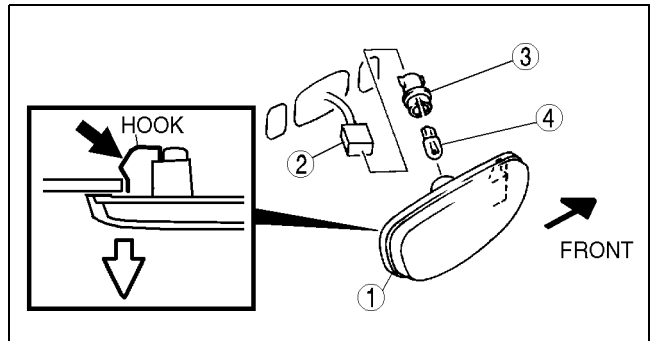

A3U0918W112

Front side marker light removal note

1. Pull out the rear end of the front side marker light while pressing the hook.

LIGHTING SYSTEMS

FRONT FOG LIGHT REMOVAL/INSTALLATION

A3U091851680W01

4SD

Caution

- A halogen bulb generates extremely high heat when it is used. If the surface of the bulb is dirty, excessive heat will build up and the bulb's life will be shortened. When replacing the bulb, hold the metal flange, not the glass.

1. Disconnect the negative battery cable.
2. Turn over the mud guard.
3. Remove in the order indicated in the table.

1	Bolt
2	Connector
3	Front fog light
4	Screw
5	Cover
6	Bulb pressing wire
7	Front fog light bulb

4. Install in the reverse order of removal.
5. Adjust the front fog light aiming. (See 09-18-9 FRONT FOG LIGHT ADJUSTMENT.)

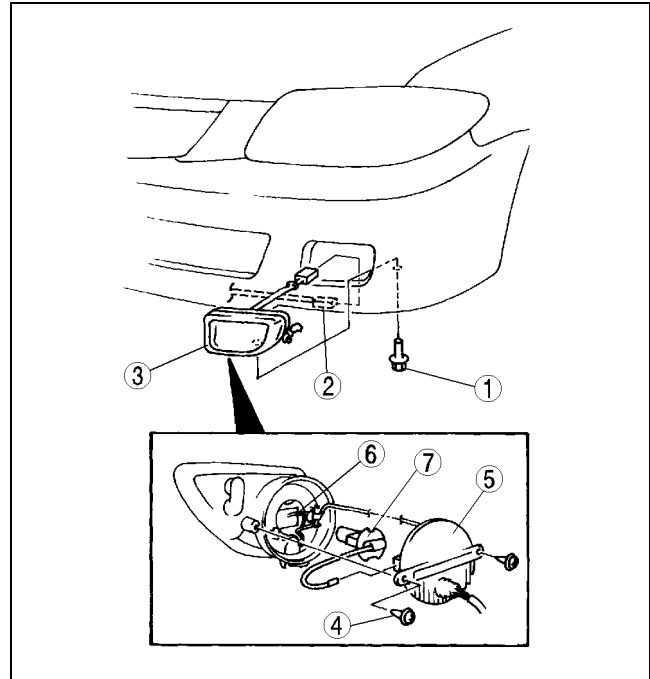

Z3U0918W014

5HB

Caution

- A halogen bulb generates extremely high heat when it is used. If the surface of the bulb is dirty, excessive heat will build up and the bulb's life will be shortened. When replacing the bulb, hold the metal flange, not the glass.

1. Disconnect the negative battery cable.
2. Remove the front bumper. (See 09-10-5 FRONT BUMPER REMOVAL/INSTALLATION.)
3. Remove in the order indicated in the table.

1	Nut
2	Connector
3	Front fog light
4	Screw
5	Front fog light unit
6	Connector
7	Bulb pressing wire
8	Front fog light bulb

4. Install in the reverse order of removal.
5. Adjust the front fog light aiming. (See 09-18-9 FRONT FOG LIGHT ADJUSTMENT.)

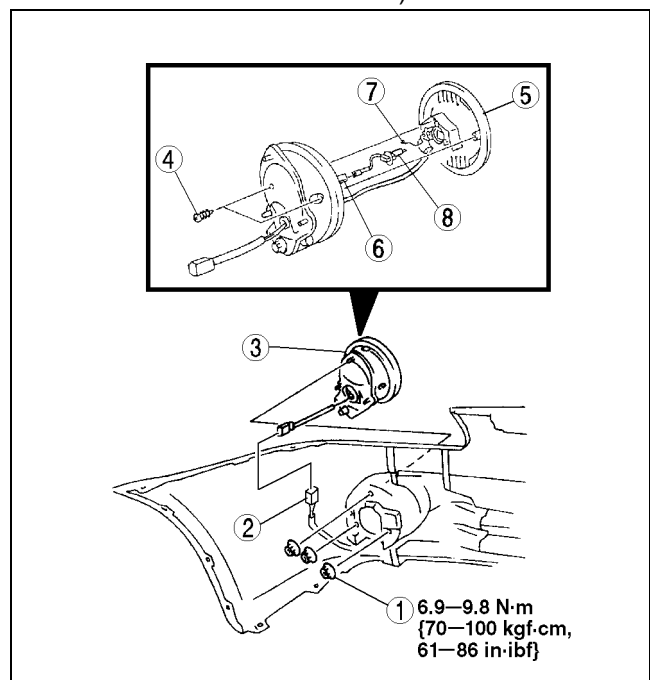

A3U0918W110

LIGHTING SYSTEMS

FRONT FOG LIGHT ADJUSTMENT

A3U091851680W02

1. Adjust the tire air pressure to the specification.
2. Position the unloaded vehicle on a flat, level surface.
3. Seat one person in the driver's seat.
4. Position the vehicle **3 m {10 ft}** in front of a white screen.
5. While adjusting one fog light, mask the other.
6. Start the engine to charge the battery.
7. Turn the front fog light on.
8. Peel off the mud guard.
9. Loosen the screw or bolts for the aim adjustment.
10. Move the front fog light in the direction of the arrows indicated in the figure and adjust the center of the front fog light to the position.

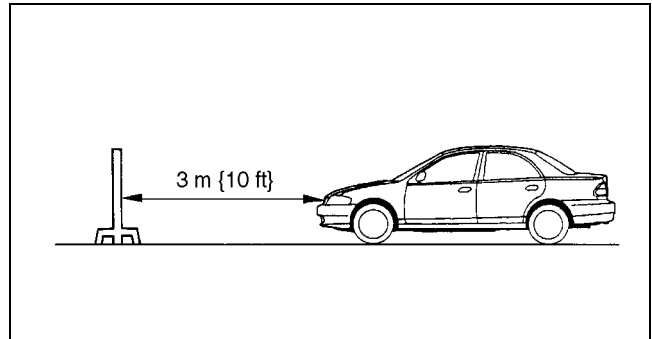

Z3U0918W006

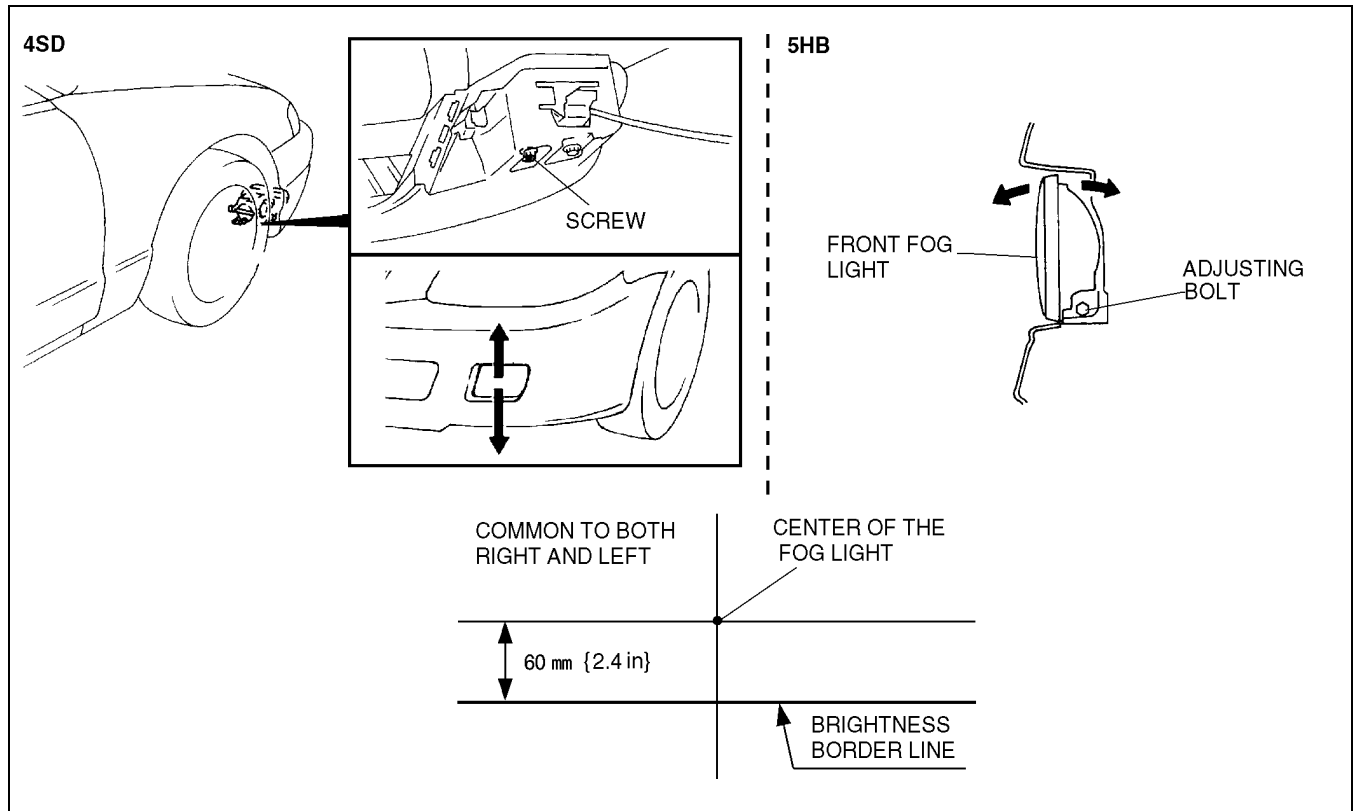

09-18

A3U0918W111

11. Tighten the front fog light adjusting screw or bolts.

LIGHTING SYSTEMS

REAR COMBINATION LIGHT REMOVAL/INSTALLATION

A3U091851150W01

1. Disconnect the negative battery cable.
2. Remove the trunk side trim. (See 09-17-15 TRUNK SIDE TRIM REMOVAL/INSTALLATION.)
3. Remove in the order indicated in the table.

1	Connector
2	Nut
3	Rear combination light
4	Socket (See 09-18-10 Socket Installation Note)
5	Brake light/taillight bulb
6	Rear turn light bulb
7	Back-up light bulb
8	Rear side marker light bulb (4SD)
9	Taillight bulb (4SD)

4. Install in the reverse order of removal.

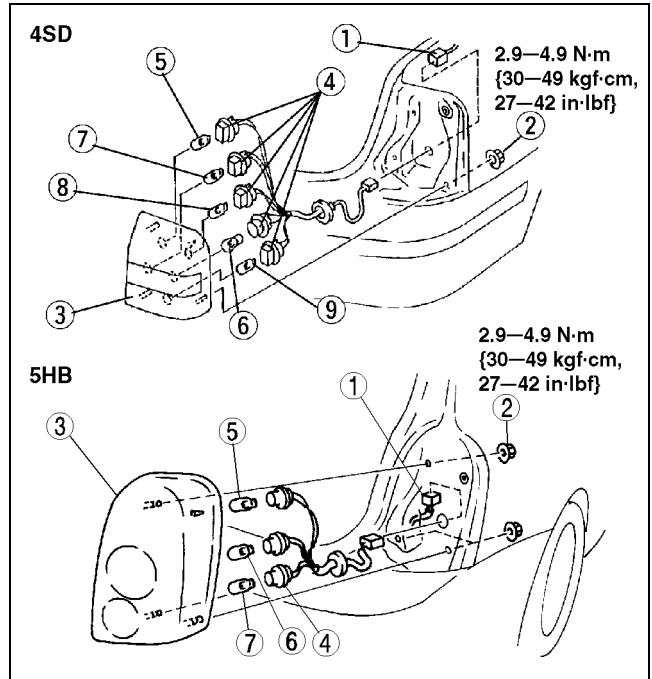

A3U0918W107

Socket Installation Note

1. Hook the harness as shown in the figure.

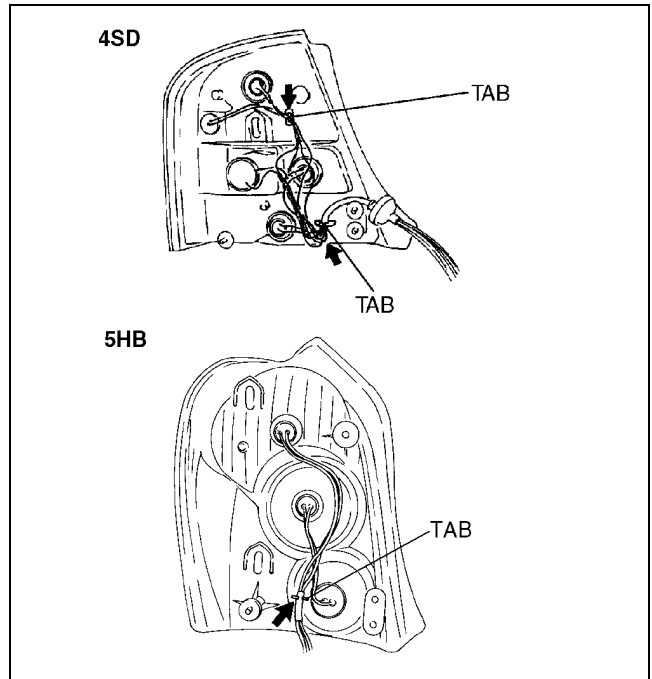

A3U0918W106

LIGHTING SYSTEMS

HIGH-MOUNT BRAKE LIGHT REMOVAL/INSTALLATION

A3U091851580W01

In-Vehicle Type

1. Disconnect the negative battery cable.
2. Remove the rear package trim. (See 09–17–12 REAR PACKAGE TRIM REMOVAL/INSTALLATION.)
3. Remove in the order indicated in the table.

1	High-mount brake light
2	Lens
3	Socket
4	High-mount brake light bulb

4. Install in the reverse order of removal.

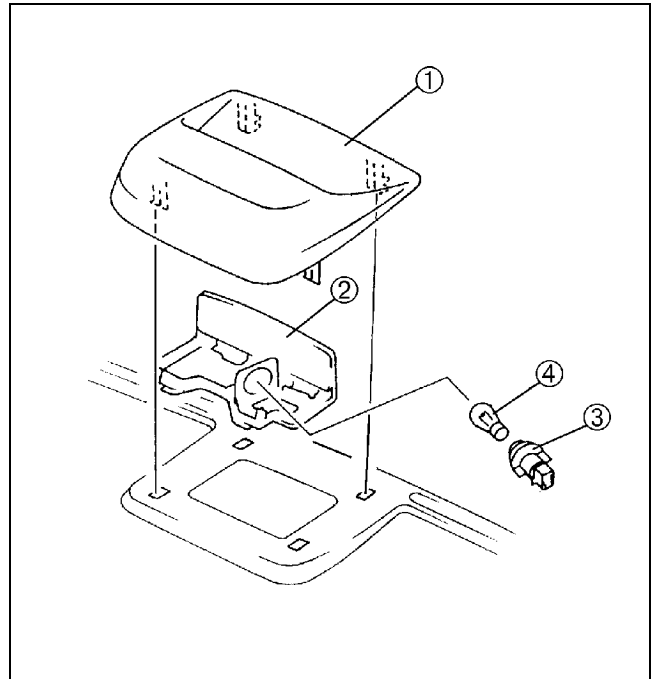

Y3U918WAM

09–18

Rear Spoiler Type

1. Disconnect the negative battery cable.
2. Remove the rear spoiler. (See 09–16–8 REAR SPOILER REMOVAL/INSTALLATION.)
3. Remove in the order indicated in the table.

1	Screw
2	High-mount brake light (See 09–18–12 High-mount brake light removal note (4SD))

4. Install in the reverse order of removal.

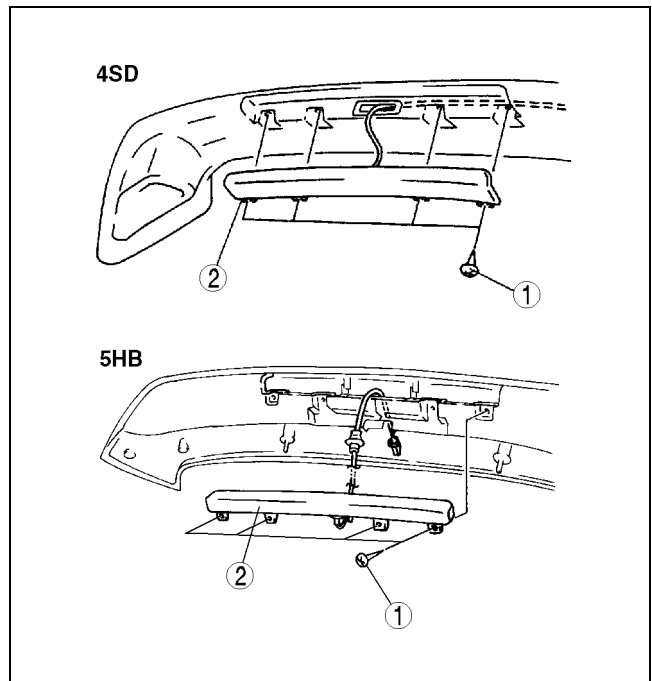

A3U0918W102

LIGHTING SYSTEMS

High-mount brake light removal note (4SD)

1. Tie a string to the end of the connector of the high-mount brake light beforehand so that the connector can be passed easily through the rear spoiler during installation.

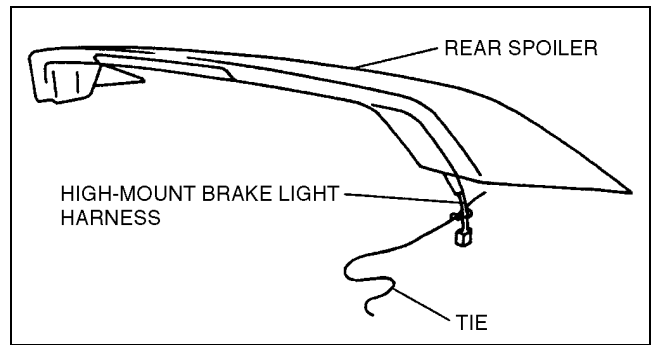

Y3U918WAJ

LICENSE PLATE LIGHT REMOVAL/INSTALLATION

A3U091851270W01

1. Disconnect the negative battery cable.
2. Remove the rear finisher. (See 09-16-3 REAR FINISHER REMOVAL/INSTALLATION.)
3. Remove in the order indicated in the table.

1	License plate light (See 09-18-12 License Plate Light Removal Note)
2	Connector
3	Socket
4	License plate light bulb

4. Install in the reverse order of removal.

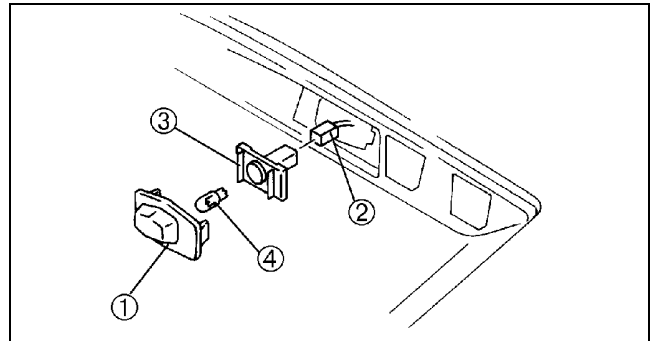

X3U918WA7

License Plate Light Removal Note

1. Slide the license plate light to the arrow mark and remove it.

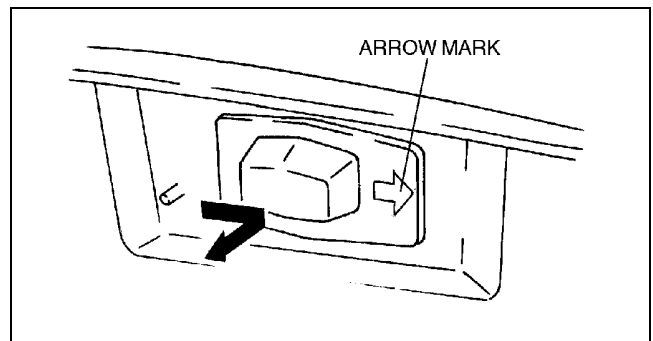

X3U918WA8

COMBINATION SWITCH REMOVAL/INSTALLATION

A3U091866120W01

1. Disconnect the negative battery cable.
2. Remove the driver-side air bag module. (See 08-10-5 DRIVER-SIDE AIR BAG MODULE REMOVAL/INSTALLATION.)
3. Remove the steering wheel. (See 06-12-6 STEERING WHEEL AND COLUMN REMOVAL/INSTALLATION.)
4. Remove the column cover. (See 09-17-5 COLUMN COVER REMOVAL/INSTALLATION.)
5. Remove the clock spring. (See 08-10-9 CLOCK SPRING REMOVAL/INSTALLATION.)
6. Remove in the order indicated in the table.

1	Connector
2	Screw
3	Combination switch

7. Install in the reverse order of removal.

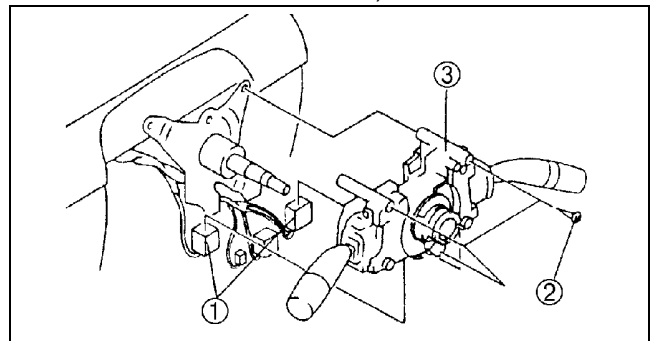

X3U918WA9

LIGHTING SYSTEMS

COMBINATION SWITCH DISASSEMBLY/ASSEMBLY

A3U091866120W02

1. Disassemble in the order indicated in the table.

1	Screw
2	Wiper lever
3	Light lever
4	Body

2. Assemble in the reverse order of disassembly.

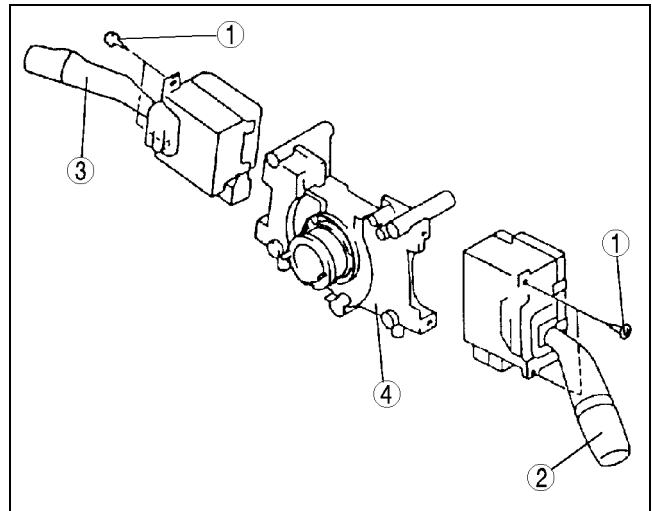

Z3U0918W003

LIGHT SWITCH REMOVAL/INSTALLATION

A3U091866121W01

1. Disconnect the negative battery cable.
2. Remove the column cover. (See 09-17-5 COLUMN COVER REMOVAL/INSTALLATION.)
3. Remove in the order indicated in the table.

1	Connector
2	Screw
3	Light lever

4. Install in the reverse order of removal.

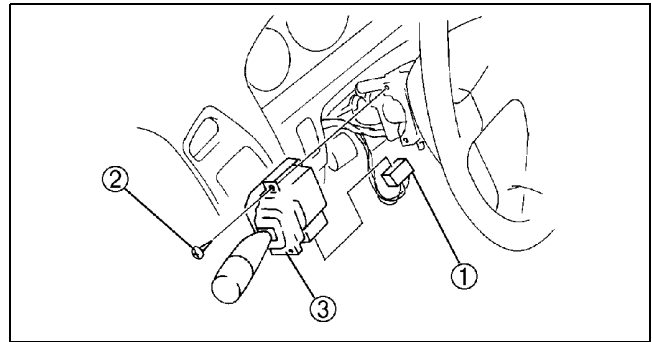

X3U918WAB

LIGHT SWITCH INSPECTION

Headlight switch

A3U091866121W02

1. Remove the light switch. (See 09-18-13 LIGHT SWITCH REMOVAL/INSTALLATION.)
2. Inspect for continuity between the light switch terminals using an ohmmeter.
 - If not as specified, replace the light switch.

○—○ : Continuity

Switch position			Terminal					
Light	Dimmer	Flash-to-pass	J	L	P	O	Q	R
OFF	-	Off						
		On			○—○	○—○		
TNS	-	Off		○—○				
		On		○—○	○—○	○—○		
Head-light	LO	Off	○—○	○—○				○
		On	○—○	○—○	○—○	○—○		
	HI	-	○—○	○—○	○—○			

Y3U918WAN

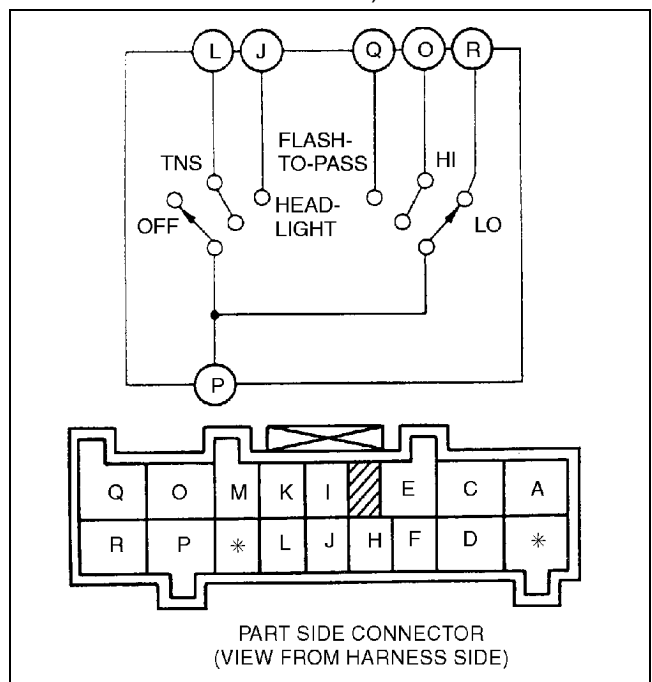

PART SIDE CONNECTOR
(VIEW FROM HARNESS SIDE)

Y3U918WAO

LIGHTING SYSTEMS

Turn switch

1. Remove the light switch. (See 09-18-13 LIGHT SWITCH REMOVAL/INSTALLATION.)
2. Inspect for continuity between the light switch terminals using an ohmmeter.
 - If not as specified, replace the light switch.

○—○ : Continuity

Switch position	Terminal		
	C	A	E
Left	○—○		
Off			
Right			○—○

X3U918WBG

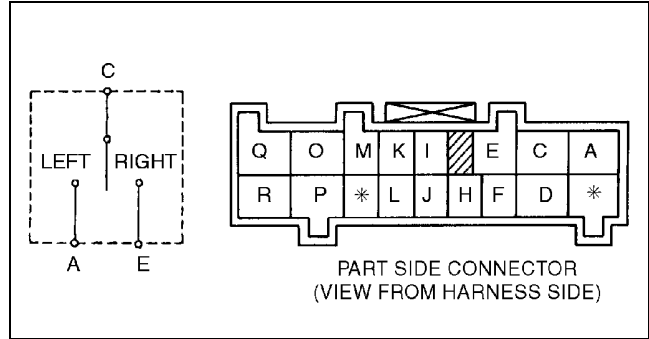

Y3U918WA1

FRONT FOG LIGHT SWITCH REMOVAL/INSTALLATION

A3U091866402W01

1. Disconnect the negative battery cable.
2. Remove the left side side panel from the dashboard.
3. Compress the tabs of the front fog light switch and pull the switch out of the dashboard.
4. Disconnect the connector to remove the front fog light switch.
5. Install in the reverse order of removal.

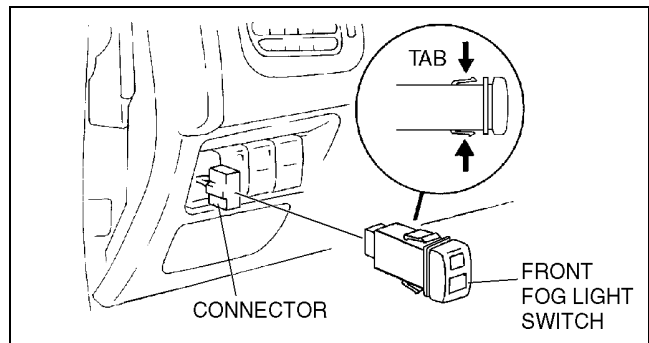

Z3U0918W009

FRONT FOG LIGHT SWITCH INSPECTION

A3U091866402W02

1. Remove the front fog light switch. (See 09-18-14 FRONT FOG LIGHT SWITCH REMOVAL/INSTALLATION.)
2. Inspect for continuity between the front fog light switch terminals using an ohmmeter.
 - If not as specified, replace the front fog light switch.

○—○ : Continuity ○○ : Bulb

Switch position	Terminal			
	A	C	B	D
Off	○○			
On	○○		○—○	

Z3U0918W008

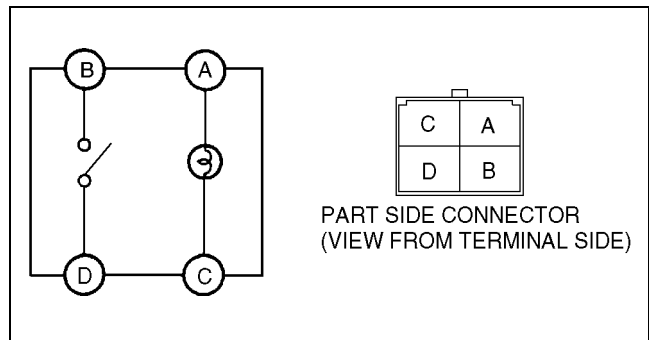

Z3U0918W007

HAZARD WARNING SWITCH REMOVAL/INSTALLATION

A3U091866401W01

1. Disconnect the negative battery cable.
2. Remove the center panel. (See 09-17-4 CENTER PANEL REMOVAL/INSTALLATION.)
3. Grasp the tabs of the hazard warning switch and pull it forward to remove it.
4. Install in the reverse order of removal.

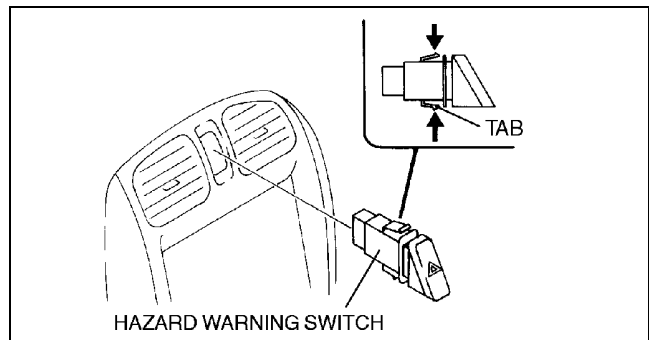

Y3U918WAP

LIGHTING SYSTEMS

HAZARD WARNING SWITCH INSPECTION

A3U091866401W02

1. Remove the hazard warning switch. (See 09-18-14 HAZARD WARNING SWITCH REMOVAL/INSTALLATION.)
2. Inspect for continuity between the hazard warning switch terminals using an ohmmeter.
 - If not as specified, replace the hazard warning switch.

○—○ : Continuity ○⊕○ : Bulb

Switch position	Terminal								
	F	D	B	A	C	I	K	H	J
OFF	○		○					○⊕○	○⊕○
ON		○	○	○	○	○	○	○⊕○	○⊕○

X3U918WBH

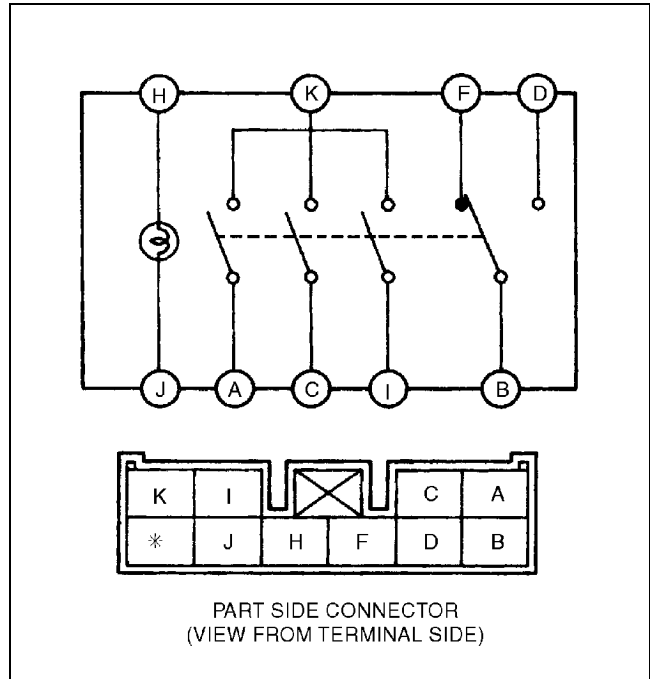

Y3U918WA2

BACK-UP LIGHT SWITCH REMOVAL/INSTALLATION

A3U091817640W01

1. Disconnect the negative battery cable.
2. Remove in the order indicated in the table.

1	Connector
2	Back-up light switch

3. Install in the reverse order of removal.

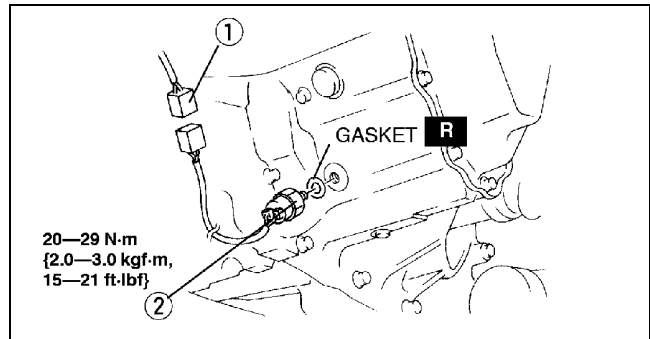

X3U918WAG

BACK-UP LIGHT SWITCH INSPECTION

A3U091817640W02

1. Disconnect the back-up light switch connector.
2. Inspect for continuity between the back-up light switch terminals using an ohmmeter.
 - If not as specified, replace the back-up light switch.

○—○ : Continuity

Shift lever position	Terminal	
	A	B
Reverse	○—○	○—○
Other		

X3U918WBJ

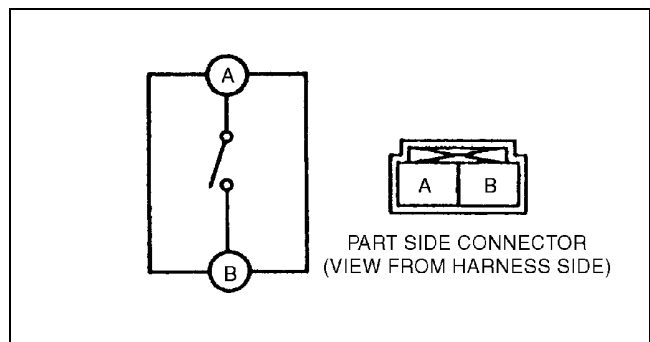

Y3U918WA3

LIGHTING SYSTEMS

FLASHER CONTROL MODULE REMOVAL/INSTALLATION

A3U091866830W01

Note

- Because the lock section of the control module is damaged easily, do not remove the control module from the bracket unless replacement is necessary. Always perform an inspection of the flasher control module before removal.

1. Disconnect the negative battery cable.
2. Remove the bracket.
3. Disconnect the flasher control module connector.
4. Remove the flasher control module by prying the lock section of the upper part with a flathead screwdriver.
5. Install in the reverse order of removal.

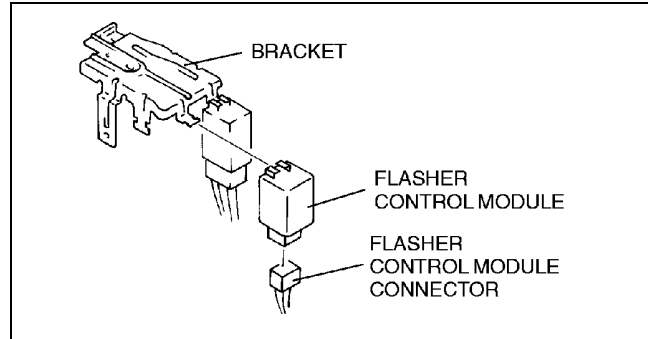

X3U918WJA1

FLASHER CONTROL MODULE INSPECTION

A3U091866830W02

1. Remove the bracket and pull it toward you.
2. Measure the voltage at the flasher control module terminals as indicated below.
3. Disconnect the flasher control module connector before inspecting for continuity at terminal F.
 - If not as specified, inspect the parts listed under "Action."
 - If the parts and wiring harnesses are okay but the system still does not work properly, replace the flasher control module.

Terminal Voltage List (Reference)

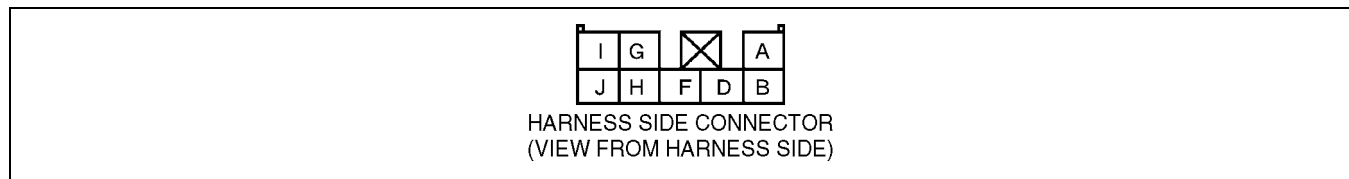

ZLU918WA6

Terminal	Signal	Connected to	Test condition	Voltage (V)/ Continuity	Action
A	Power supply	HAZARD 15 A fuse	Under any condition	B+	<ul style="list-style-type: none"> • Inspect HAZARD 15 A fuse • Inspect related harness
B	—	—	—	—	—
D	Turn signal flasher (LH)	Turn signal light (LH)	Turn signal light (LH) flashes.	Alternates below 1.0 and B+	<ul style="list-style-type: none"> • Inspect turn signal light (LH) • Inspect related harness
			Hazard warning switch at on position.		
			Other	Below 1.0	
F	Flasher control module ground	GND	Constant: inspect for continuity to ground.	Yes	<ul style="list-style-type: none"> • Inspect GND
G	Turn signal flasher (RH)	Turn signal light (RH)	Turn signal light (RH) flashes.	Alternates below 1.0 and B+	<ul style="list-style-type: none"> • Inspect turn signal light (RH) • Inspect related harness
			Hazard warning switch at on position.		
			Other	Below 1.0	
H	Hazard warning on	Hazard warning switch	Hazard warning switch at on position.	Below 1.0	<ul style="list-style-type: none"> • Inspect hazard warning switch (See 09–18–15 HAZARD WARNING SWITCH INSPECTION) • Inspect related harness
			Hazard warning switch at off position.	B+	
I	Turn switch on/off (RH)	Combination switch (light switch)	Ignition switch is at ON and turn switch (RH) on.	B+	<ul style="list-style-type: none"> • Inspect light switch (See 09–18–13 LIGHT SWITCH INSPECTION) • Inspect TURN 10 A fuse • Inspect related harness
			Other	Below 1.0	
J	Turn switch on/off (LH)	Combination switch (light switch)	Ignition switch is at ON and turn switch (LH) on.	B+	<ul style="list-style-type: none"> • Inspect light switch (See 09–18–13 LIGHT SWITCH INSPECTION) • Inspect TURN 10 A fuse • Inspect related harness
			Other	Below 1.0	

LIGHTING SYSTEMS

DAYTIME RUNNING LIGHT (DRL) SYSTEM WIRING DIAGRAM

A3U091867750W01

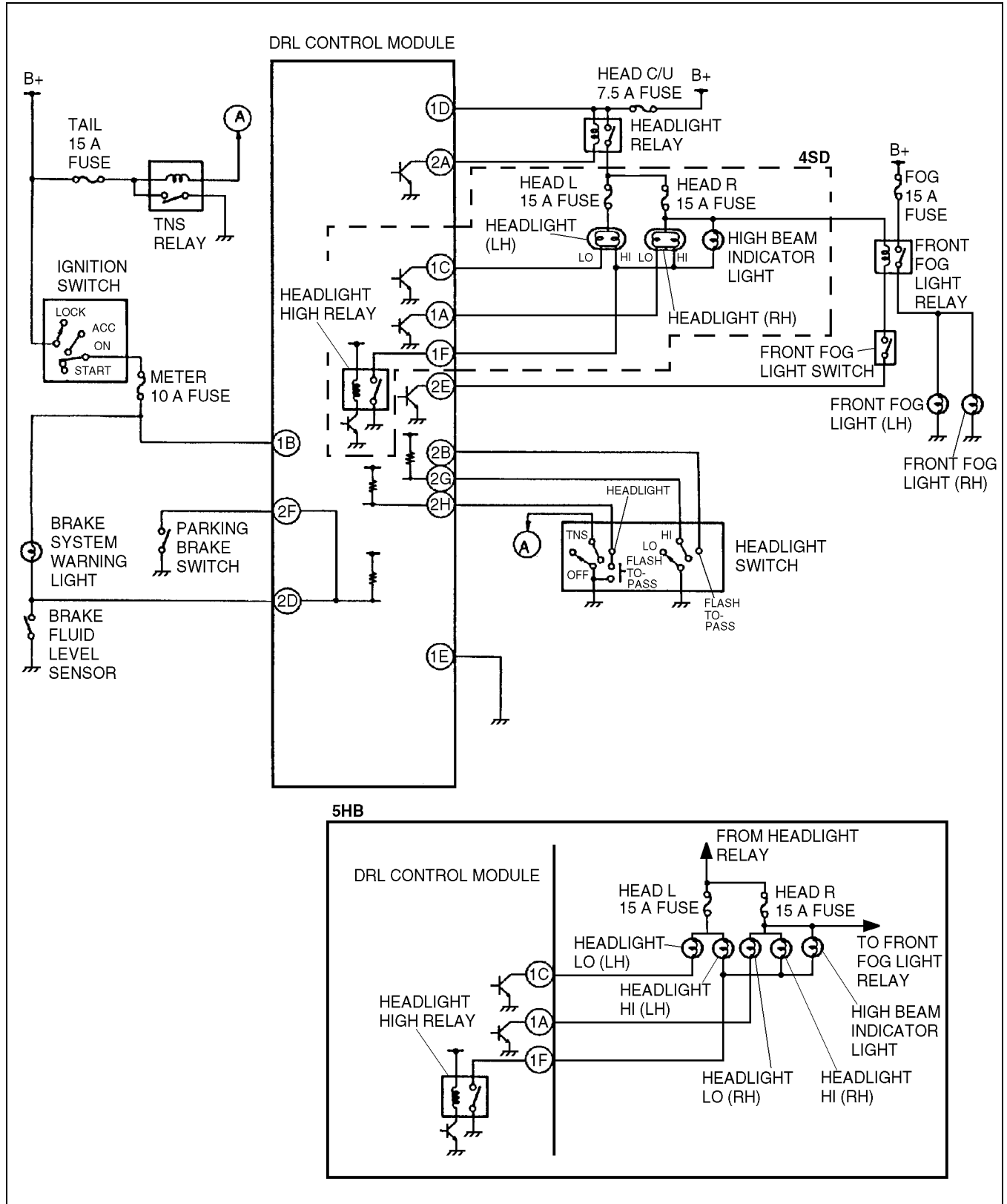

09-18

A3U0918W105

LIGHTING SYSTEMS

DRL CONTROL MODULE REMOVAL/INSTALLATION (CANADA)

A3U091867750W02

Note

- Because the lock section of the control module is damaged easily, do not remove the control module from the bracket unless replacement is necessary. Always perform an inspection of the DRL control module before removal.

- Remove the negative battery cable.
- Remove the bracket.
- Disconnect the DRL control module connector.
- Remove the DRL control module by prying the lock section of the side part with a flathead screwdriver.
- Install in the reverse order of removal.

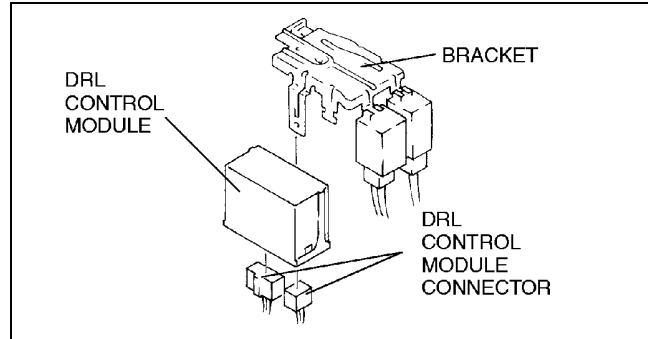

X3U918WAL

DRL CONTROL MODULE INSPECTION (CANADA)

A3U091867750W03

- Remove the bracket and pull it toward you.
- Measure the voltage at the DRL control module terminals as indicated below.
- Disconnect the DRL control module connector before inspecting for continuity at terminal 1E.
 - If not as specified, inspect the parts listed under "Action."
 - If the parts and wiring harnesses are okay but the system still does not work properly, replace the DRL control module.

Terminal Voltage List (Reference)

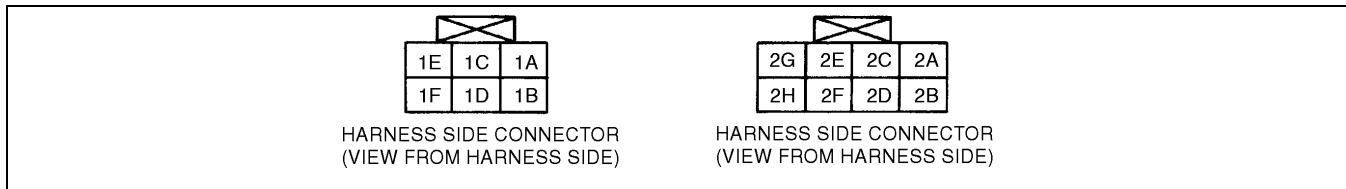

Y3U918WA7

Terminal	Signal	Connected to	Test condition		Voltage (V)/ Continuity	Action	
			Headlight switch at headlight position	Dimmer switch at high beam position			
1A	RH headlight operation (low beam)	RH headlight (low beam)	Headlight switch at headlight position	4SD	B+	<ul style="list-style-type: none"> Inspect HEAD R 15 A fuse Inspect RH headlight Inspect related harness 	
				5HB	Below 1.5		
			Headlight switch at OFF or TNS position		Below 1.5		
1B	IG1	METER 10 A fuse	Ignition switch at ON position		B+	<ul style="list-style-type: none"> Inspect METER 10 A fuse Inspect related harness 	
			Ignition switch at LOCK or ACC position		Below 1.0		
1C	LH headlight operation (low beam)	LH headlight (low beam)	Headlight switch at headlight position	Dimmer switch at high beam position	4SD	B+	<ul style="list-style-type: none"> Inspect HEAD L 15 A fuse Inspect LH headlight Inspect related harness
				5HB	Below 1.5		
			Dimmer switch at low beam position		Below 1.5		
Headlight switch at OFF or TNS position		Below 1.5					
1D	Power supply	HEAD C/U 7.5 A fuse	Under any condition		B+	<ul style="list-style-type: none"> Inspect HEAD C/U 7.5 A fuse Inspect related harness 	
1E	DRL control module ground	GND	Constant: inspect for continuity to ground		Yes	<ul style="list-style-type: none"> Inspect related harness 	

LIGHTING SYSTEMS

Terminal	Signal	Connected to	Test condition		Voltage (V)/ Continuity	Action
1F	Headlight operation (high beam)	Headlight (high beam)	Headlight switch at headlight position	Dimmer switch at high beam position	Below 1.0	<ul style="list-style-type: none"> Inspect headlight Inspect HEAD R 15 A fuse Inspect HEAD L 15 A fuse Inspect related harness
				Dimmer switch at low beam position	B+	
			Headlight switch at OFF or TNS position	Below 1.0		
2A	Headlight relay operation	Headlight relay	Headlight switch at headlight position		Below 1.0	<ul style="list-style-type: none"> Inspect headlight relay (See 09-21-5 RELAY INSPECTION) Inspect related harness
			Headlight switch at OFF or TNS position		B+	
2B	Flash-to-pass on/off	Headlight switch	Flash-to-pass activated		Below 1.0	<ul style="list-style-type: none"> Inspect combination switch Inspect related harness
			Flash-to-pass not activated		B+	
2C	—	—	—		—	—
2D	Brake system warning light operation	<ul style="list-style-type: none"> Brake system warning light Brake fluid level sensor 	Ignition switch at ON position	Brake fluid level is below MIN.	Below 1.0	<ul style="list-style-type: none"> Inspect METER 10 A fuse Inspect instrument cluster (See 09-22-4 INSTRUMENT CLUSTER INSPECTION) Inspect brake fluid level sensor (See 04-11-9 FLUID LEVEL SENSOR INSPECTION) Inspect related harness
				Brake fluid level is above MIN.	B+	
			Ignition switch at LOCK or ACC position		Below 1.0	
2E	Front fog light relay operation	Front fog light switch	<ul style="list-style-type: none"> Headlight switch at headlight position Front fog light switch on 	Dimmer switch at high beam position	B+	<ul style="list-style-type: none"> Inspect front fog light relay (See 09-21-5 RELAY INSPECTION) Inspect related harness
				Dimmer switch at low beam position	Below 1.5	
2F	Parking brake lever pulled/released	Parking brake switch	Parking brake lever pulled		Below 1.0	<ul style="list-style-type: none"> Inspect parking brake switch Inspect related harness
			Parking brake lever released		B+	
2G	High beam on/off	Headlight switch	Dimmer switch at high beam position		Below 1.0	<ul style="list-style-type: none"> Inspect combination switch Inspect related harness
			Dimmer switch at low beam position		B+	
2H	Headlight switch on/off	Headlight switch	Headlight switch at headlight position		Below 1.0	<ul style="list-style-type: none"> Inspect combination switch Inspect related harness
			Headlight switch at OFF or TNS position		B+	

LIGHTING SYSTEMS

INTERIOR AND MAP LIGHT REMOVAL/INSTALLATION

A3U091851310W01

1. Disconnect the negative battery cable.
2. Remove in the order indicated in the table.

1	Lens (See 09-18-20 Lens Removal Note)
2	Interior light bulb
3	Map light bulb
4	Screw
5	Interior and map light
6	Connector

3. Install in the reverse order of removal.

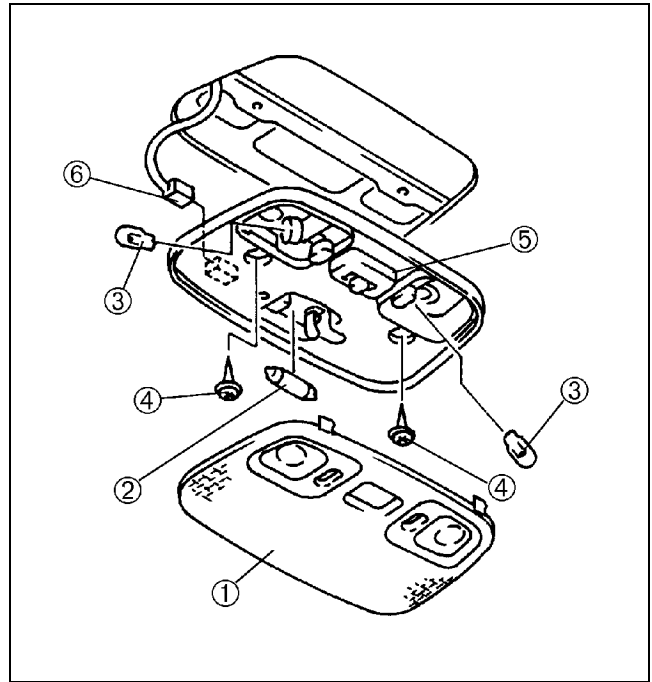

X3U918WAW

Lens Removal Note

1. Insert a tape-wrapped, flathead screwdriver into the service hole.
2. Twist the flathead screwdriver in the direction indicated by the arrow to remove the lens.

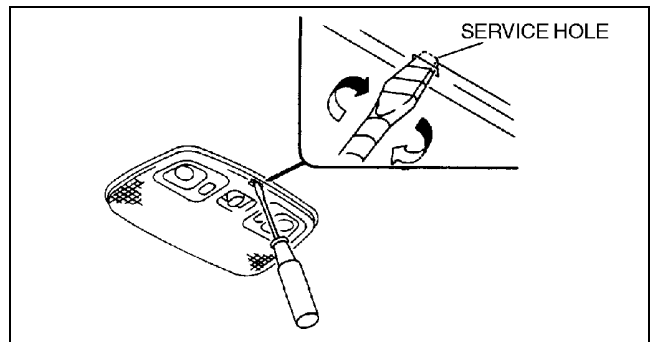

X3U918WAX

INTERIOR AND MAP LIGHT INSPECTION

A3U091851310W02

1. Remove the interior and map light. (See 09-18-20 INTERIOR AND MAP LIGHT REMOVAL/INSTALLATION.)
2. Inspect for continuity between the interior and map light terminals using an ohmmeter.
 - If not as specified, replace the interior and map light.

○—○ : Bulb

Switch position	Terminal		
	A	B	Body GND
Map light switch	ON	○—○	○—○
	OFF		○—○
Interior light switch	ON	○—○	○—○
	DOOR	○—○	
	OFF		

Y3U918WAK

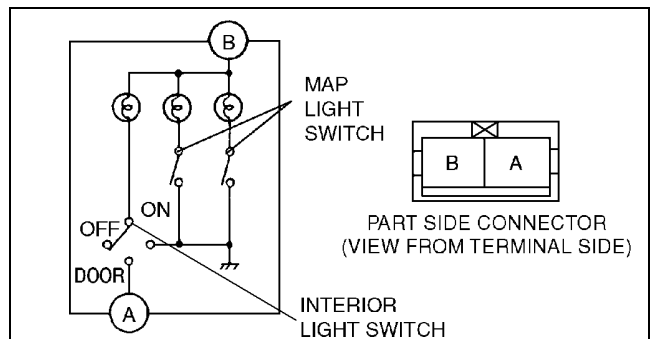

Z3U0918W004

LIGHTING SYSTEMS

MAP LIGHT REMOVAL/INSTALLATION

A3U091851310W03

1. Disconnect the negative battery cable.
2. Remove in the order indicated in the table.

1	Lens (See 09-18-21 Lens Removal Note)
2	Map light bulb
3	Map light
4	Connector

3. Install in the reverse order of removal.

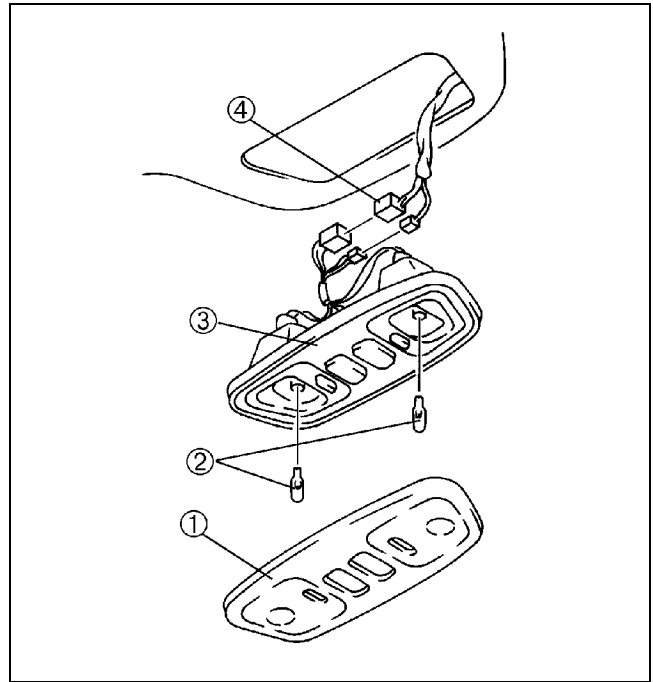

X3U918WAZ

Lens Removal Note

1. Insert a tape-wrapped, flathead screwdriver into the service hole.
2. Twist the flathead screwdriver in the direction indicated by the arrow to remove the lens.

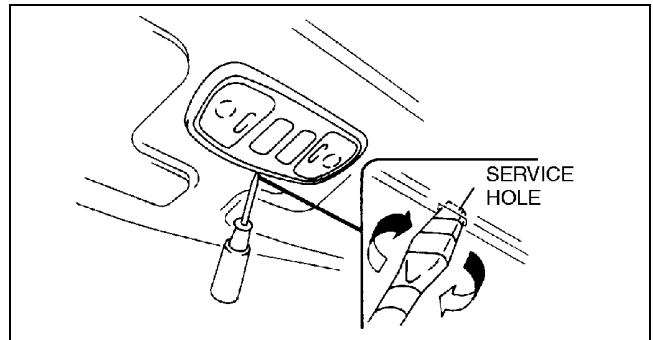

X3U918WB0

09-18

MAP LIGHT INSPECTION

A3U091851310W04

1. Remove the map light. (See 09-18-21 MAP LIGHT REMOVAL/INSTALLATION.)
2. Inspect for continuity between the map light terminals using an ohmmeter.
 - If not as specified, replace the map light.

○ ⊕ ○ : Bulb

Switch position	Terminal	
	1A	2B
ON	○ — ⊕ — ○	
OFF		

X3U918WBN

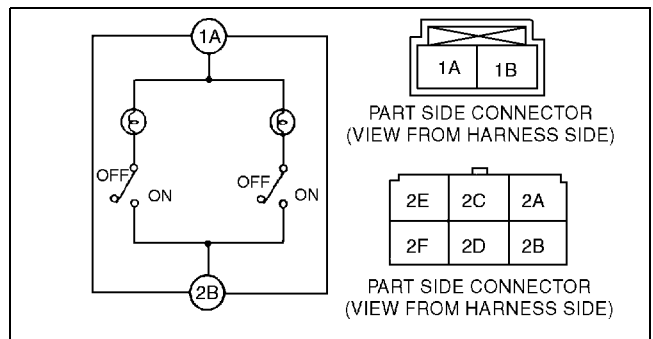

Y3U918WAB

LIGHTING SYSTEMS

A3U091869970W01

INTERIOR LIGHT REMOVAL/INSTALLATION

1. Disconnect the negative battery cable.
2. Remove in the order indicated in the table.

1	Lens (See 09-18-22 Lens Removal Note)
2	Interior light bulb
3	Screw
4	Interior light
5	Connector

3. Install in the reverse order of removal.

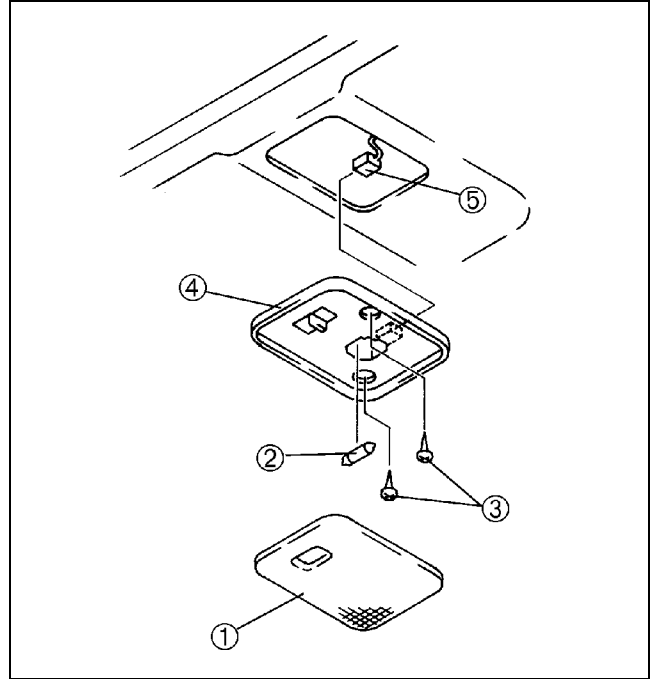

X3U918WB2

Lens Removal Note

1. Insert a tape-wrapped, flathead screwdriver into the service hole.
2. Twist the flathead screwdriver in the direction indicated by the arrow to remove the lens.

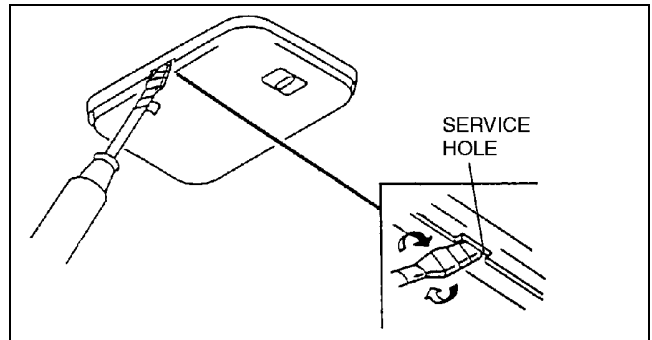

X3U918WB3

INTERIOR LIGHT INSPECTION

A3U091869970W02

1. Remove the interior light. (See 09-18-22 INTERIOR LIGHT REMOVAL/INSTALLATION.)
2. Inspect for continuity between the interior light terminals using an ohmmeter.
 - If not as specified, replace the interior light.

○ ⊕ ○ : Bulb

Switch position	Terminal		
	A	B	Body GND
ON		○ ⊕ ○	
DOOR	○ ⊕ ○		
OFF			

X3U918WBP

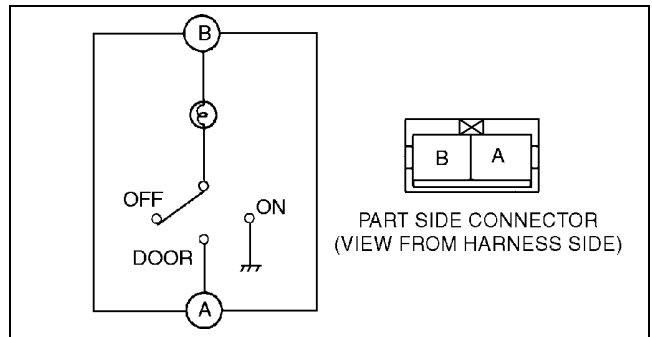

Z3U0918W005

LIGHTING SYSTEMS

TRUNK COMPARTMENT LIGHT BULB REMOVAL/INSTALLATION

A3U091851440W01

1. Disconnect the negative battery cable.
2. Pinch the sides of the lens and pull down to remove.
3. Remove the bulb.
4. Install in the reverse order of removal.

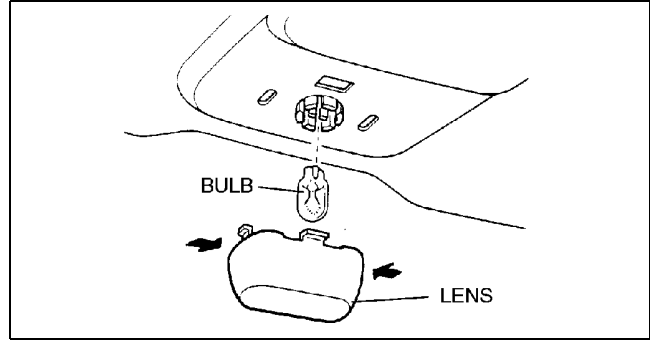

X3U918WB5

TRUNK COMPARTMENT LIGHT SWITCH INSPECTION

A3U091851440W02

Note

- Trunk compartment light switch has a built-in trunk lid lock.

1. Disconnect the trunk compartment light switch connector.
2. Inspect for continuity between the trunk compartment light switch terminal and a body ground using an ohmmeter.
 - If not as specified, replace the trunk lid lock.

○—○ : Continuity

Switch position	Terminal	
	A	B
Locked (trunk lid closed)		
Unlocked (trunk lid opened)	○—○	○—○

X3U918WBQ

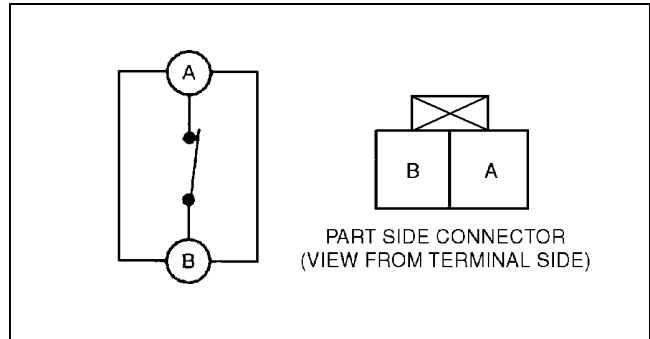

Y3U918WAD

09-18

CARGO COMPARTMENT LIGHT REMOVAL/INSTALLATION

A3U091851441W01

1. Disconnect the negative battery cable.
2. Pinch the sides of the lens and pull to remove.
3. Remove the cargo compartment light bulb.
4. Push the area indicated by the arrow and pull to remove the cargo compartment light.
5. Disconnect the connectors.
6. Install in the reverse order of removal.

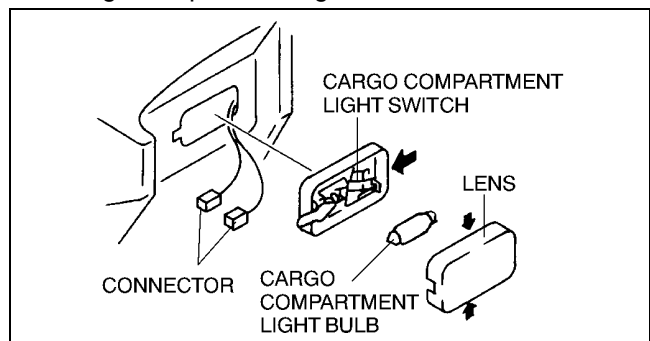

A3U0918W005

LIGHTING SYSTEMS

CARGO COMPARTMENT LIGHT INSPECTION

A3U091851441W02

1. Remove the cargo compartment light. (See 09–18–23 CARGO COMPARTMENT LIGHT REMOVAL/INSTALLATION.)
2. Inspect for continuity between the cargo compartment light terminals using an ohmmeter.
 - If not as specified, replace the cargo compartment light.

○—○ : Bulb

Switch position	Terminal	
	A	B
ON	○—○	
OFF		

YMU918WB7

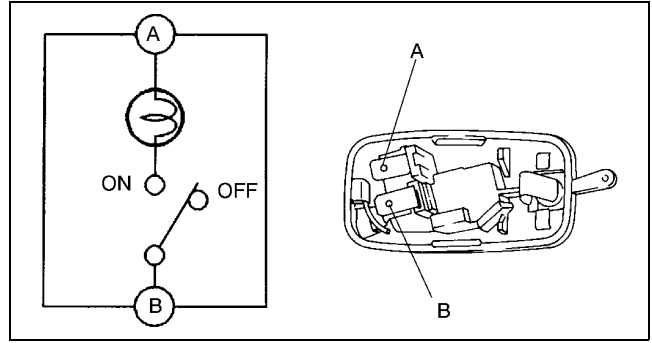

A3U0918W007

CARGO COMPARTMENT LIGHT SWITCH INSPECTION

A3U091851442W01

1. Remove the liftgate trim. (See 09–17–16 LIFTGATE TRIM REMOVAL/INSTALLATION.)
2. Disconnect the cargo compartment light switch connector.
3. Inspect for continuity between the cargo compartment light switch terminals using an ohmmeter.
 - If not as specified, replace the liftgate lock.

○—○ : Continuity

Switch position	Terminal	
	A	B
On (liftgate open)	○—○	○—○
Off (liftgate closed)		

YMU918WB9

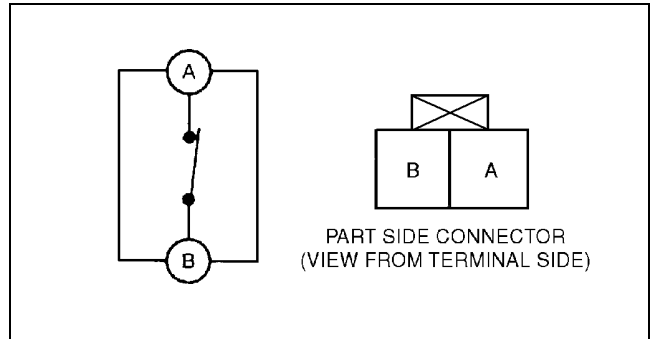

Y3U918WAD

IGNITION KEY ILLUMINATION BULB REMOVAL/INSTALLATION

A3U091860231W01

1. Disconnect the negative battery cable.
2. Remove the column cover.
3. Remove the ignition key illumination bulb.
4. Install in the reverse order of removal.

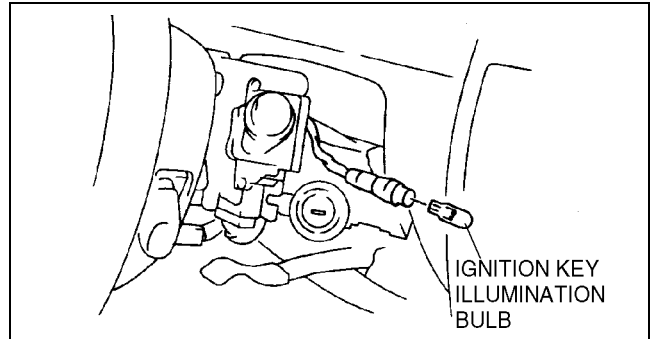

Z3U0918W015

DOOR SWITCH REMOVAL/INSTALLATION

A3U091866540W01

Front

1. Disconnect the negative battery cable.
2. Remove in the order indicated in the table.

1	Screw
2	Connector
3	Door switch

3. Install in the reverse order of removal.

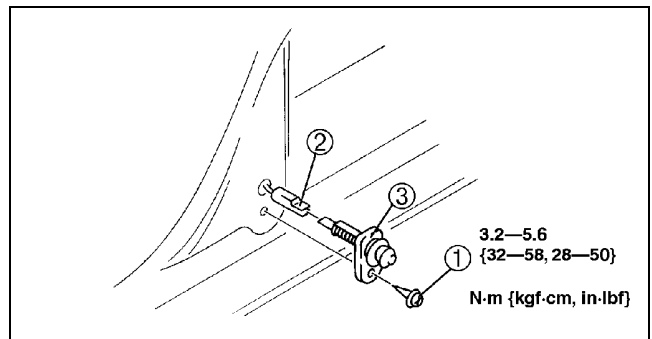

Y3U918WAE

LIGHTING SYSTEMS

Rear

1. Disconnect the negative battery cable.
2. Remove in the order indicated in the table.

1	Screw
2	Connector
3	Door switch

3. Install in the reverse order of removal.

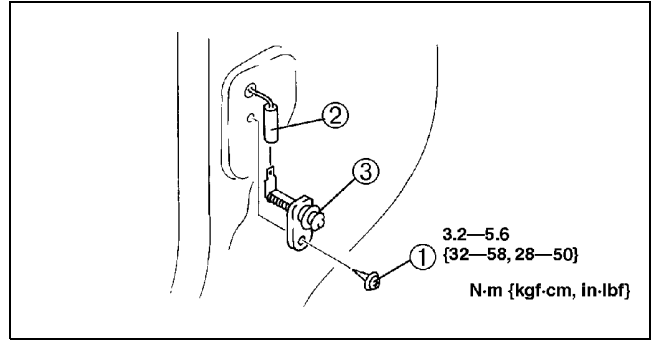

Y3U918WAF

DOOR SWITCH INSPECTION

1. Remove the door switch. (See 09-18-24 DOOR SWITCH REMOVAL/INSTALLATION.)
2. Inspect for continuity between the door switch terminal and a body ground using an ohmmeter.
 - If not as specified, replace the door switch.

A3U091866540W02

○—○ : Continuity

Switch position	Terminal	
	A	Body GND
Pressed		
Released	○—○	○—○

X3U918WBR

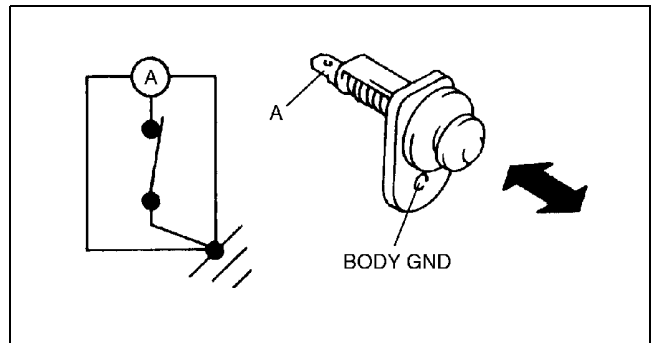

X3U918WB9

PANEL LIGHT CONTROL SWITCH REMOVAL/INSTALLATION

1. Disconnect the negative battery cable.
2. Remove the driver-side side panel.
3. Remove in the order indicated in the table.

A3U091866600W01

1	Panel light control switch (See 09-18-25 Panel Light Control Switch Removal Note)
2	Connector

4. Install in the reverse order of removal.

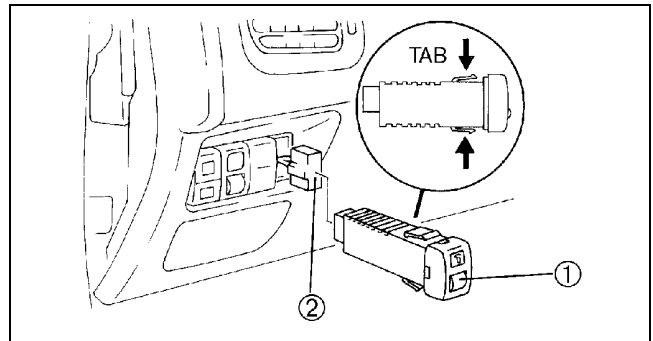

Y3U918WAS

Panel Light Control Switch Removal Note

1. Insert your hand into the hole in the driver-side side panel, grasp the tabs of the panel light control switch and pull it forward to remove.

LIGHTING SYSTEMS

PANEL LIGHT CONTROL SWITCH INSPECTION

A3U091866600W02

1. Remove the panel light control switch. (See 09–18–25 PANEL LIGHT CONTROL SWITCH REMOVAL/INSTALLATION.)
2. Connect the negative battery cable.
3. Connect the connector to the panel light control switch.
4. Measure the voltage at the panel light control switch as indicated below.
5. Disconnect the panel light control switch connector before inspecting for continuity at terminal D.
 - If not as specified, inspect the parts listed under “Action.”
 - If the parts and wiring harnesses are okay but the system still does not work properly, replace the panel light control switch.

Terminal Voltage List (Reference)

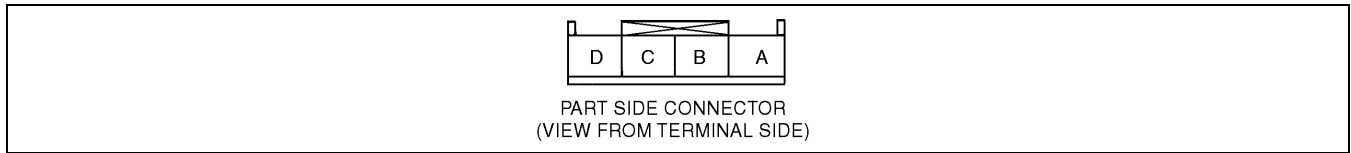

Y3U918WAG

Terminal	Signal	Connected to	Test condition	Voltage (V)/Continuity	Action
A	—	—	—	—	—
B	TNS	TNS relay	Headlight switch at TNS or headlight position	B+	<ul style="list-style-type: none"> • Inspect TNS relay • Inspect combination switch • Inspect TAIL 15 A fuse • Inspect related harness
			Other	Below 1.0	
C	Illumination	Each illumination	Inspect using an oscilloscope (See 09–18–26 Terminal C inspection)	—	<ul style="list-style-type: none"> • Inspect each illumination • Inspect related harness
D	Ground	GND	Constant: inspect for continuity to ground	Yes	<ul style="list-style-type: none"> • Inspect GND

Terminal C inspection

1. Measure the wave pattern of the C terminal on the panel light control switch using an oscilloscope.
2. Set the headlight switch to either the TNS or headlight position.
3. Set the panel light control switch to the brightest position.

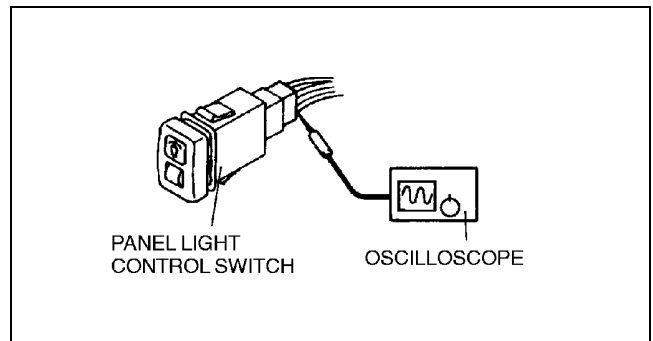

X3U918WBC

4. Verify that the pattern on the screen is as shown in the figure.

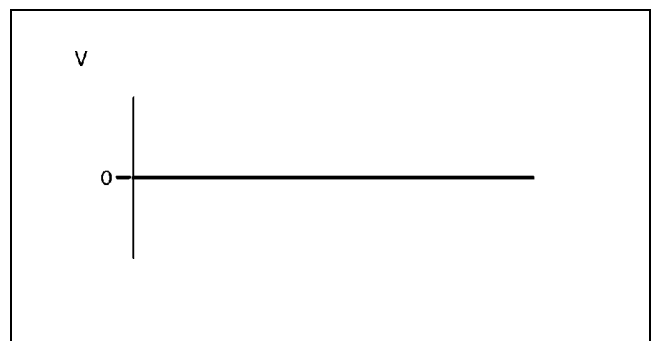

X3U918WBD

LIGHTING SYSTEMS

5. Verify that the pattern on the screen matches the pattern shown in the figure as the panel light control switch is gradually turned to the darkest position.

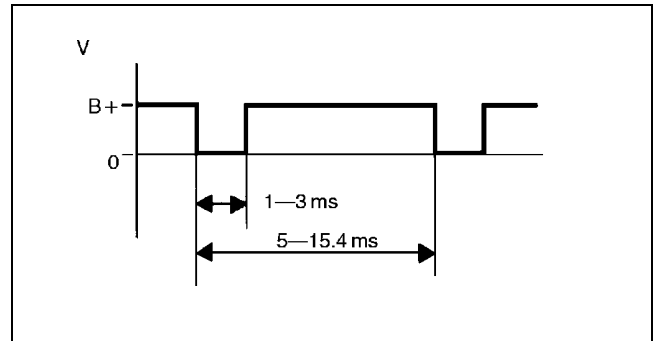

X3U918WBE