

04-12 PARKING BRAKE SYSTEM

PARKING BRAKE SYSTEM
LOCATION INDEX 04-12-1
PARKING BRAKE (LEVER TYPE)
INSPECTION..... 04-12-1

PARKING BRAKE (LEVER TYPE)
ADJUSTMENT04-12-1
PARKING BRAKE (LEVER TYPE)
REMOVAL/INSTALLATION.....04-12-2

PARKING BRAKE SYSTEM LOCATION INDEX

A3U041244000W01

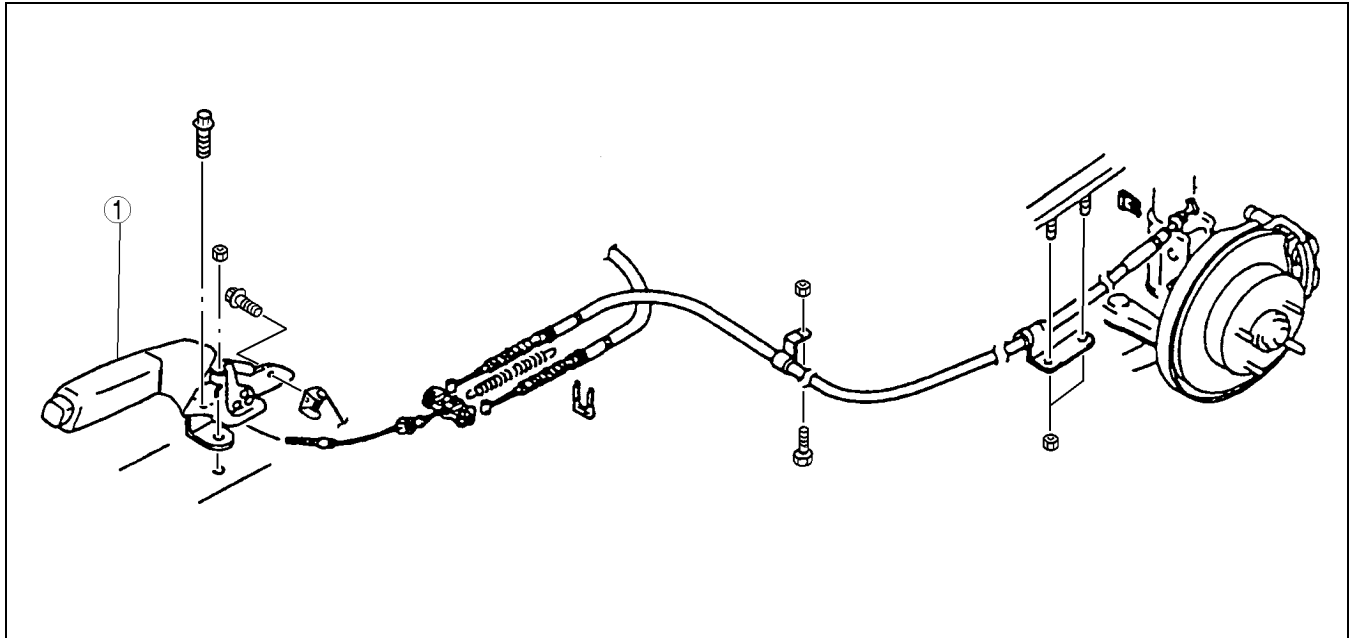

A3U0412W001

1	Parking brake (See 04-12-1 PARKING BRAKE (LEVER TYPE) INSPECTION) (See 04-12-1 PARKING BRAKE (LEVER TYPE) ADJUSTMENT) (See 04-12-2 PARKING BRAKE (LEVER TYPE) REMOVAL/INSTALLATION)
---	--

PARKING BRAKE (LEVER TYPE) INSPECTION

A3U041244000W02

1. Pull the parking brake lever a few times.
2. Depress the brake pedal a few times.
3. Inspect the parking brake stroke by pulling the parking brake lever with a force of **98 N {10 kgf, 22 lbf}**.

Stroke
5—7 notches

PARKING BRAKE (LEVER TYPE) ADJUSTMENT

A3U041244000W03

1. Start the engine and depress the brake pedal several times.
2. Stop the engine.
3. Turn the adjusting nut at the front of the parking cable.
4. After adjustment, inspect the following points:
 - (1) Turn the ignition switch to ON, pull the parking brake lever one notch, and verify that the parking brake warning light illuminates.
 - (2) Verify that the rear brakes do not drag.

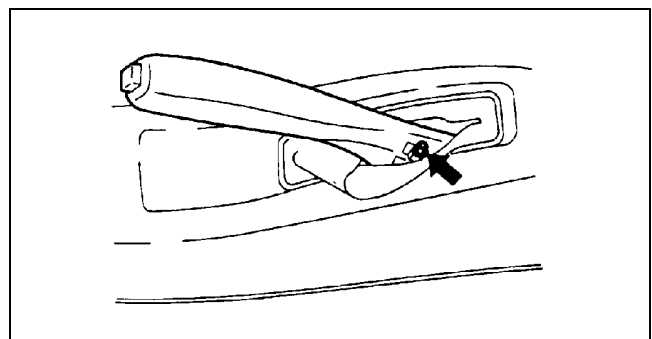

X3U412WAO

04-12

PARKING BRAKE SYSTEM

PARKING BRAKE (LEVER TYPE) REMOVAL/INSTALLATION

A3U04124400W04

1. Remove the rear console. (See 09-17-5 CONSOLE REMOVAL/INSTALLATION.)
2. Remove the exhaust pipe insulator bolts.
3. Remove in the order indicated in the table.
4. Install in the reverse order of removal.
5. Adjust the parking brake stroke. (See 04-12-1 PARKING BRAKE (LEVER TYPE) ADJUSTMENT.)

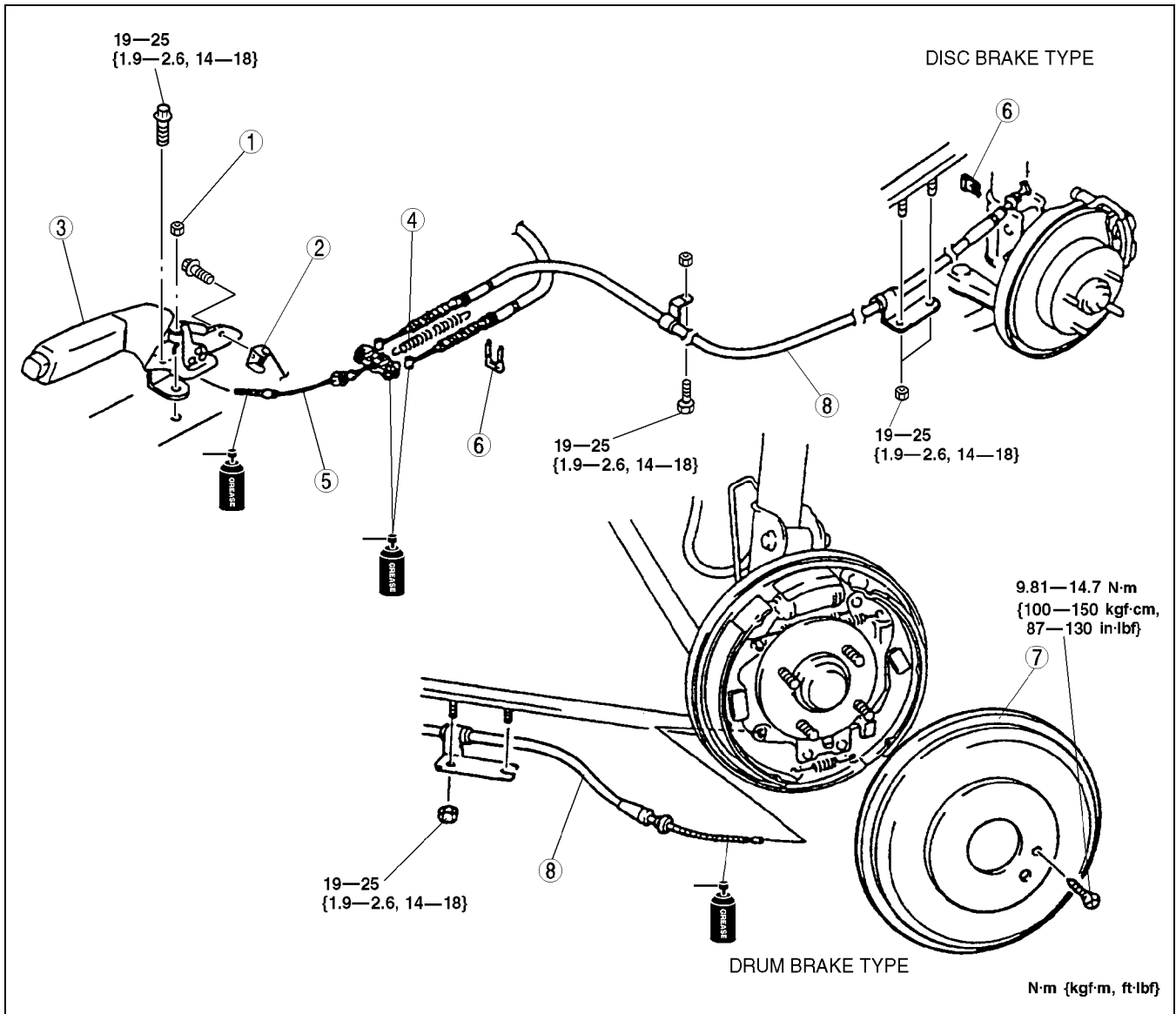

A3U0412W002

1	Adjusting nut
2	Parking brake switch
3	Parking brake lever
4	Return spring

5	Front cable and equalizer
6	Clip
7	Brake drum
8	Parking brake cable